

DRM DOOR HARDWARE, BIFOLD & STACKING SYSTEMS



C.R. LAURENCE OF AUSTRALIA PTY LTD.

Phone 1800 424 275 | Fax 1800 813 013 | crlaurence.com.au



DRM80 AND DRM100 DOOR RAILS

CRL DRM Door Rails are 2-piece extruded aluminium clamping systems that are tightened with cap screws at 100 mm centre to centre. These systems are suitable for the installation of heavy-duty wide doors. There are two heights of 80 mm (DRM80) and 100 mm (DRM100) to choose from and in lengths based on your requirement.

With its clamping efficiency carefully considered, CRL DRM Door rails do not require any glass preparation and can be used with various glass thickness such as 10/12/15 mm. In addition, there is a choice of both satin anodised & brushed aluminium snap-on cover plates.

CRL Door Rails are also available with secure locking devices featuring key cylinders or thumb-turn cylinders.

To complete the aesthetic facade of the glass panels, we offer matching sidelight rail packages.

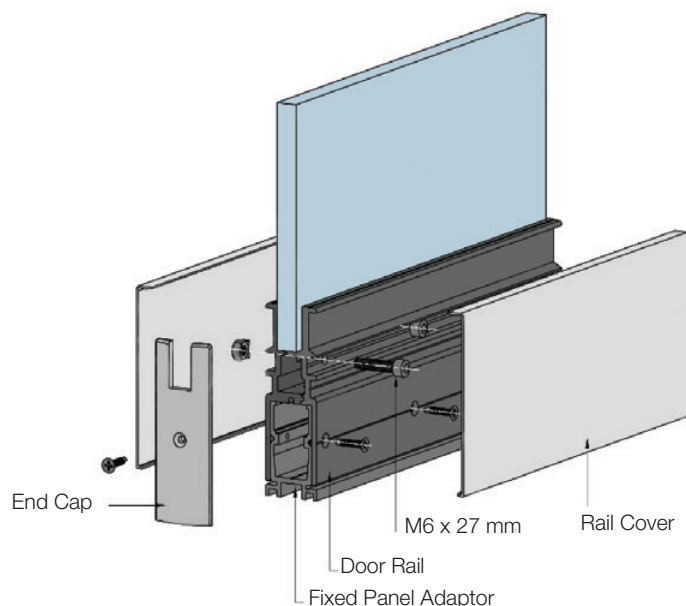

TYPICAL DOOR LAYOUT

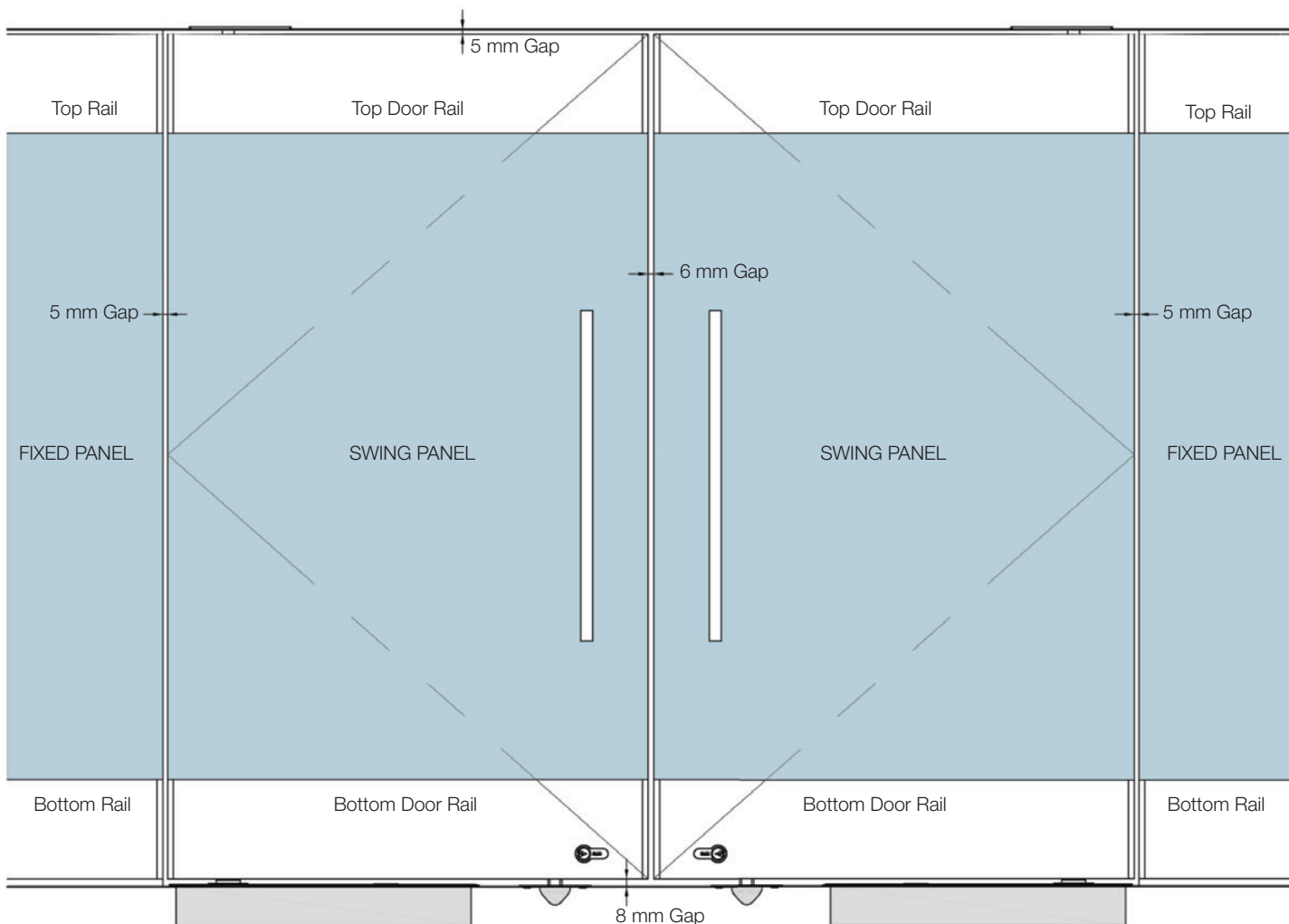

CRL CUSTOM LENGTH DOOR RAIL SYSTEMS - AUSTRALIA

80 mm Rail Kits

12 MM GLASS

TOP RAILS STANDARD

CAT. NO.	CUSTOM SIZE	FINISH
DRM80TSA12	500 mm - 1000 mm	Satin Anodised
DRM80TBS12	500 mm - 1000 mm	Brushed Aluminium
DRM80TSA12X	1001 mm - 1500 mm	Satin Anodised
DRM80TBS12X	1001 mm - 1500 mm	Brushed Aluminium

TOP RAILS FOR OVERHEAD CLOSER

CAT. NO.	CUSTOM SIZE	FINISH
DRM80TCSA12	500 mm - 1000 mm	Satin Anodised
DRM80TCBS12	500 mm - 1000 mm	Brushed Aluminium
DRM80TCSA12X	1001 mm - 1500 mm	Satin Anodised
DRM80TCBS12X	1001 mm - 1500 mm	Brushed Aluminium

BOTTOM RAILS STANDARD

CAT. NO.	CUSTOM SIZE	FINISH
DRM80BSA12	500 mm - 1000 mm	Satin Anodised
DRM80BBS12	500 mm - 1000 mm	Brushed Aluminium
DRM80BSA12X	1001 mm - 1500 mm	Satin Anodised
DRM80BBS12X	1001 mm - 1500 mm	Brushed Aluminium

BOTTOM RAILS WITH EURO LOCK KEY-KEY

CAT. NO.	CUSTOM SIZE	FINISH
DRM80BSA12L	500 mm - 1000 mm	Satin Anodised
DRM80BBS12L	500 mm - 1000 mm	Brushed Aluminium
DRM80BSA12XL	1001 mm - 1500 mm	Satin Anodised
DRM80BBS12XL	1001 mm - 1500 mm	Brushed Aluminium

BOTTOM RAILS WITH EURO LOCK KEY-THUMBTURN

CAT. NO.	CUSTOM SIZE	FINISH
DRM80BSA12LT	500 mm - 1000 mm	Satin Anodised
DRM80BBS12LT	500 mm - 1000 mm	Brushed Aluminium
DRM80BSA12XLT	1001 mm - 1500 mm	Satin Anodised
DRM80BBS12XLT	1001 mm - 1500 mm	Brushed Aluminium

BOTTOM RAILS WITH 590 LOCK KEY-KEY

CAT. NO.	CUSTOM SIZE	FINISH
DRM80BSA12L59	500 mm - 1000 mm	Satin Anodised
DRM80BBS12L59	500 mm - 1000 mm	Brushed Aluminium
DRM80BSA12XL59	1001 mm - 1500 mm	Satin Anodised
DRM80BBS12XL59	1001 mm - 1500 mm	Brushed Aluminium

BOTTOM RAILS WITH 590 LOCK KEY-THUMBTURN

CAT. NO.	CUSTOM SIZE	FINISH
DRM80BSA12LT5	500 mm - 1000 mm	Satin Anodised
DRM80BBS12LT5	500 mm - 1000 mm	Brushed Aluminium
DRM80BSA12XLT5	1001 mm - 1500 mm	Satin Anodised
DRM80BBS12XLT5	1001 mm - 1500 mm	Brushed Aluminium

Rails Manufactured as Standard for 12 mm Glass.
Use Additional Gasket Cat. No. DRMG1MM for 10 mm Glass.

100 mm Rail Kits

15 MM GLASS

TOP RAILS STANDARD

CAT. NO.	CUSTOM SIZE	FINISH
DRM100TSA15	500 mm - 1000 mm	Satin Anodised
DRM100TBS15	500 mm - 1000 mm	Brushed Aluminium
DRM100TSA15X	1001 mm - 1500 mm	Satin Anodised
DRM100TBS15X	1001 mm - 1500 mm	Brushed Aluminium

TOP RAILS FOR OVERHEAD CLOSER

CAT. NO.	CUSTOM SIZE	FINISH
DRM100TCSA15	500 mm - 1000 mm	Satin Anodised
DRM100TCBS15	500 mm - 1000 mm	Brushed Aluminium
DRM100TCSA15X	1001 mm - 1500 mm	Satin Anodised
DRM100TCBS15X	1001 mm - 1500 mm	Brushed Aluminium

BOTTOM RAILS STANDARD

CAT. NO.	CUSTOM SIZE	FINISH
DRM100BSA15	500 mm - 1000 mm	Satin Anodised
DRM100BBS15	500 mm - 1000 mm	Brushed Aluminium
DRM100BSA15X	1001 mm - 1500 mm	Satin Anodised
DRM100BBS15X	1001 mm - 1500 mm	Brushed Aluminium

BOTTOM RAILS WITH EURO LOCK KEY-KEY

CAT. NO.	CUSTOM SIZE	FINISH
DRM100BSA15L	500 mm - 1000 mm	Satin Anodised
DRM100BBS15L	500 mm - 1000 mm	Brushed Aluminium
DRM100BSA15XL	1001 mm - 1500 mm	Satin Anodised
DRM100BBS15XL	1001 mm - 1500 mm	Brushed Aluminium

BOTTOM RAILS WITH EURO LOCK KEY-THUMBTURN

CAT. NO.	CUSTOM SIZE	FINISH
DRM100BSA15LT	500 mm - 1000 mm	Satin Anodised
DRM100BBS15LT	500 mm - 1000 mm	Brushed Aluminium
DRM100BSA15XLT	1001 mm - 1500 mm	Satin Anodised
DRM100BBS15XLT	1001 mm - 1500 mm	Brushed Aluminium

BOTTOM RAILS WITH 590 LOCK KEY-KEY

CAT. NO.	CUSTOM SIZE	FINISH
DRM100BSA15L59	500 mm - 1000 mm	Satin Anodised
DRM100BBS15L59	500 mm - 1000 mm	Brushed Aluminium
DRM100BSA15XL59	1001 mm - 1500 mm	Satin Anodised
DRM100BBS15XL59	1001 mm - 1500 mm	Brushed Aluminium

BOTTOM RAILS WITH 590 LOCK KEY-THUMBTURN

CAT. NO.	CUSTOM SIZE	FINISH
DRM100BSA15LT5	500 mm - 1000 mm	Satin Anodised
DRM100BBS15LT5	500 mm - 1000 mm	Brushed Aluminium
DRM100BSA15XLT5	1001 mm - 1500 mm	Satin Anodised
DRM100BBS15XLT5	1001 mm - 1500 mm	Brushed Aluminium

Rails Manufactured as Standard for 12 - 15 mm Glass.
Use Additional Gasket Cat. No. DRMG1MM for 10 mm Glass.

Sidelite Rail Kits

CAT. NO.	SIZE	RAIL HEIGHT	GLASS SIZE
DRM80FKSA12	2900 mm	80 mm	10 mm to 12 mm
DRM80FKBS12	2900 mm	80 mm	10 mm to 12 mm
DRM100FKSA12	2900 mm	80 mm	10 mm to 12 mm
DRM100FKBS12	2900 mm	80 mm	10 mm to 12 mm

Rails Manufactured as Standard for 12 mm Glass. Use Additional Gasket Cat. No. DRMG1MM for 10 mm Glass.

End Caps

CAT. NO.	FINISH	END CAP HEIGHT	UM
EC80SNA	Satin Anodised	80 mm	EA
EC80B	Brushed Aluminium	80 mm	EA
EC100NA15	Satin Anodised	100 mm	PR
EC100B15	Brushed Aluminium	100 mm	PR

DRM80

DRM80 Door Rails are available with the following standard components:

- DRM80 Rails
- DRMPD24NS15 Top Pivot
- DRM911715 Top Pivot Block
- DRM9123L Door Strap
- PL2 Lock Bolt
- GGHPM88 Euro-Profile Key Cylinder
- GGH9137 Keeper Cup

NOTE: Usage of Door Rails will determine the specific components required, therefore it will differ from the listed standard components.

When placing an order, please specify the following:

- **Usage of Door Rails**
Floor Spring
Overhead Concealed Door Closer
Free Pivot Door
- **Length of Door Rails**
(Glass Panel Width is Required)
- **Door Rails Covers**
Snap-On Aluminium Cover
Brushed Aluminium Finish
Satin Anodised Aluminium Finish
- **Glass Thickness**
(10 mm /12 mm)
- **Key Combinations**
Independent - Supplied as standard
Keyed Alike - Available on request
- **Lock Type**
Standard Euro Profile
590 Style

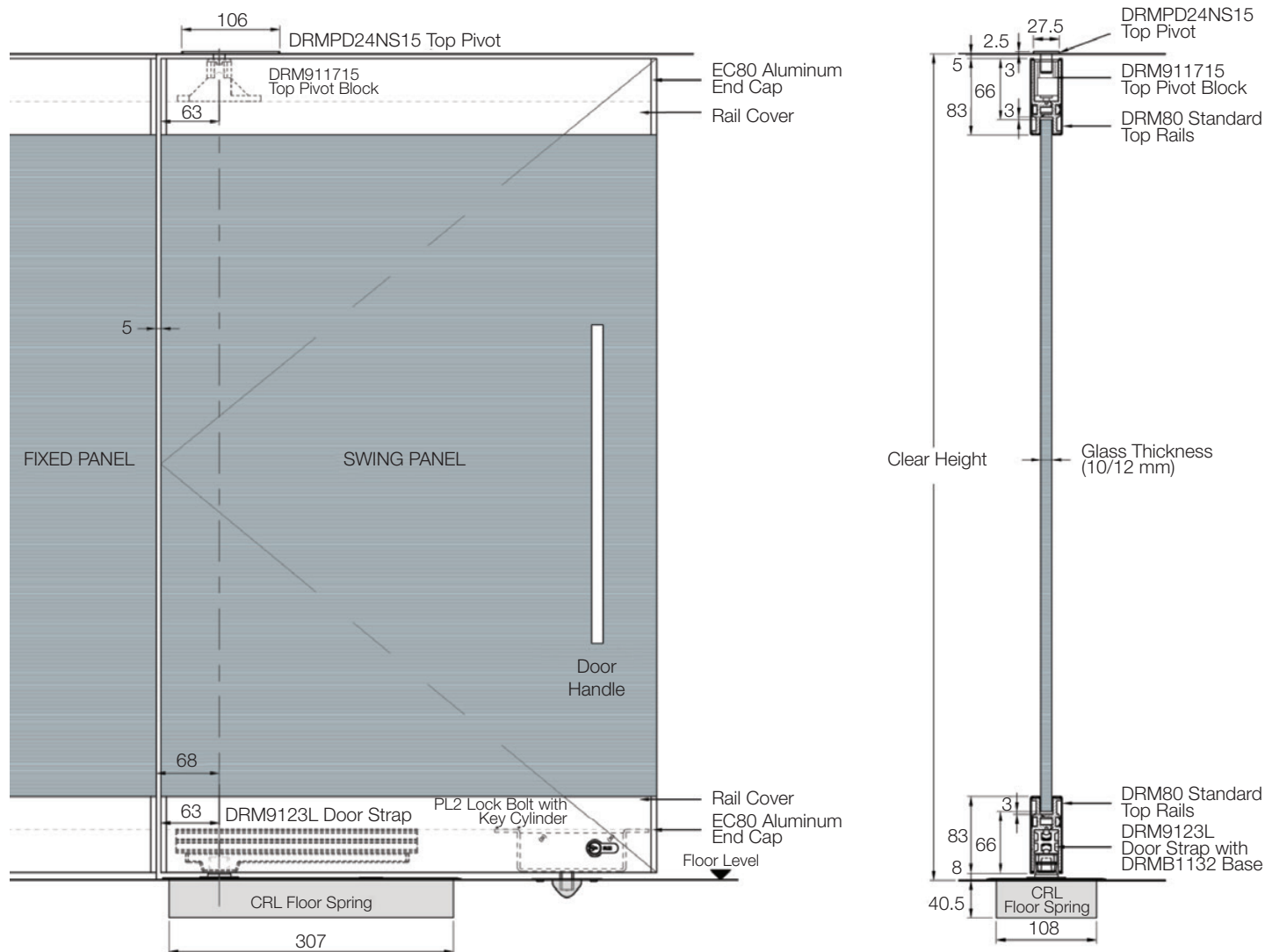

DRM100

DRM100 Door Rails are available with the following standard components:

- DRM100 Rails
- DRMPD24NS15 Top Pivot
- DRM911715 Top Pivot Block
- DRM9123L Door Strap
- PL2 Lock Bolt
- GGHPM88 Euro-Profile Key Cylinder
- GGH9137 Keeper Cup

NOTE: Usage of Door Rails will determine the specific components required, therefore it will differ from the listed standard components.

When placing an order, please specify the following:

- **Usage of Door Rails**
Floor Spring
Overhead Concealed Door Closer
Free Pivot Door
- **Length of Door Rails**
(Glass Panel Width is Required)
- **Door Rails Covers**
Snap-On Aluminium Cover
Brushed Aluminium Finish
Satin Anodised Aluminium Finish
- **Glass Thickness**
(15 mm)
- **Key Combinations**
Independent - Supplied as standard
Keyed Alike - Available on request
- **Lock Type**
Standard Euro Profile

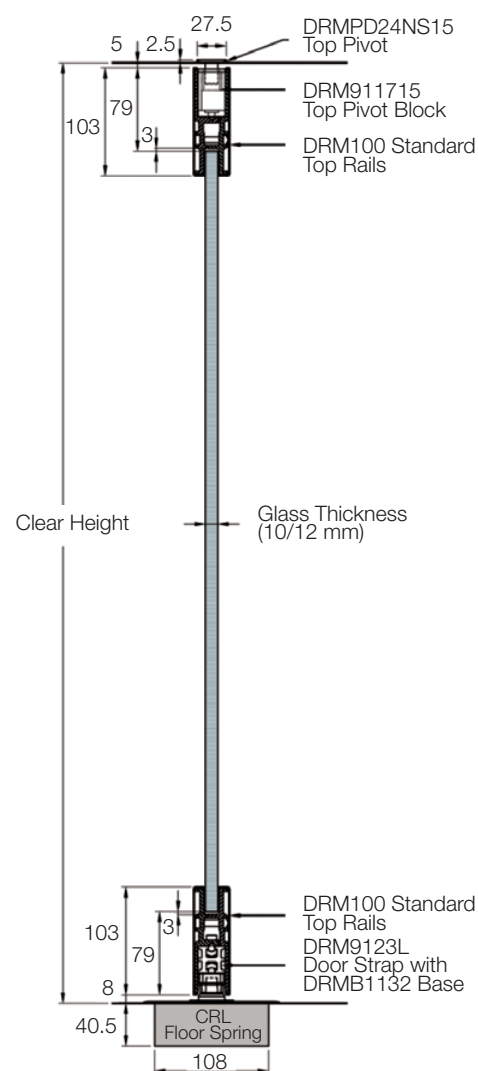
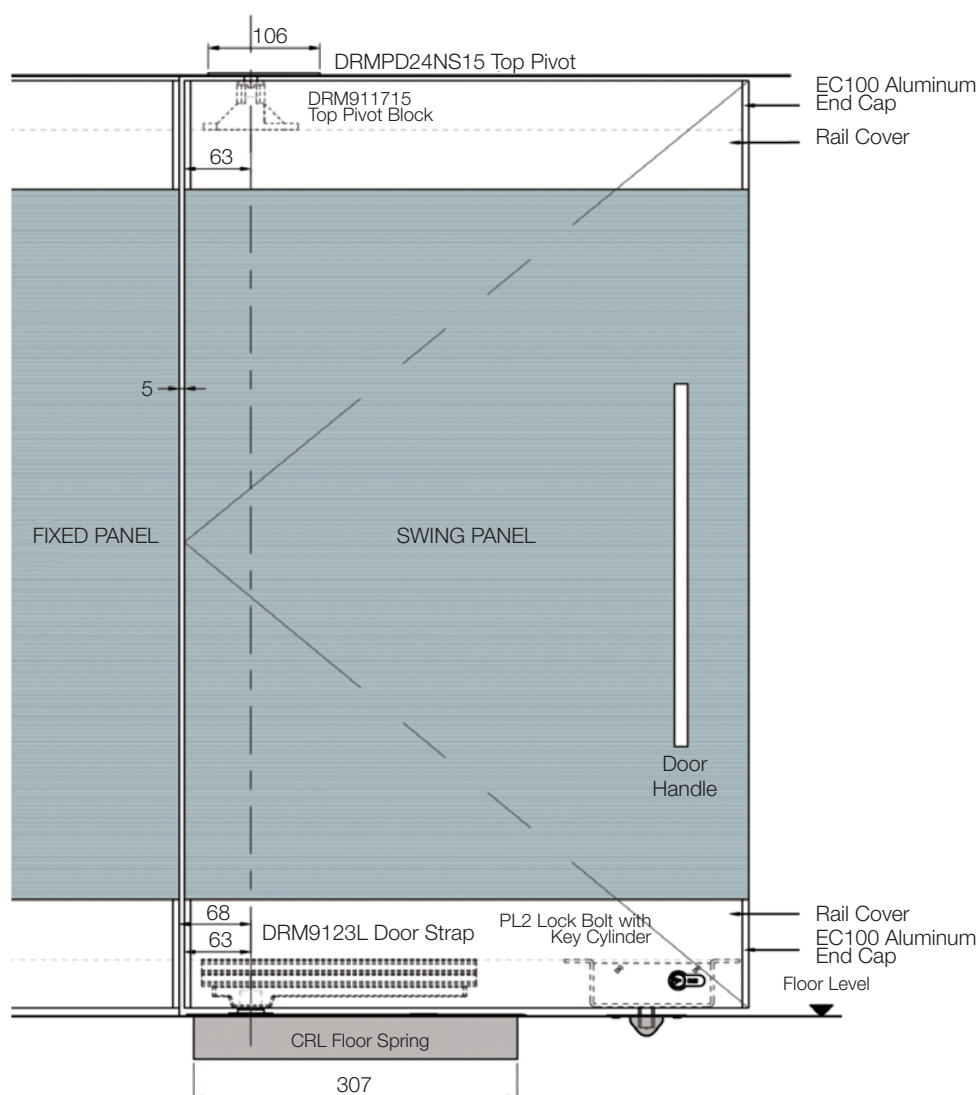

TOP RAIL ACCESSORIES

DRMPD24NS15 Top Pivot

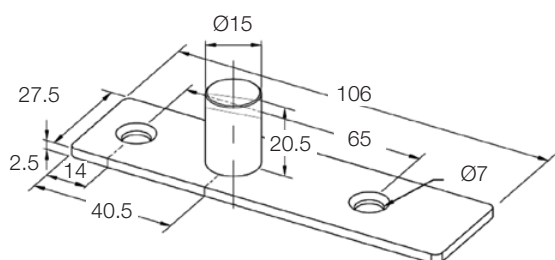

DRM911715 Top Pivot Block

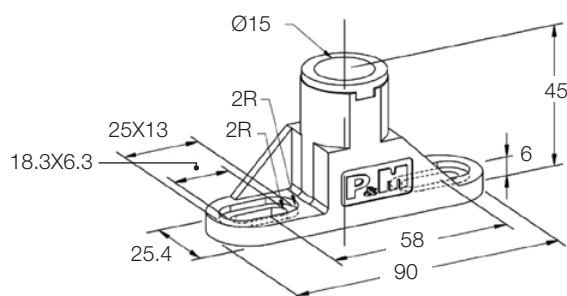

LOCK ACCESSORIES

PL2 Lock Bolt

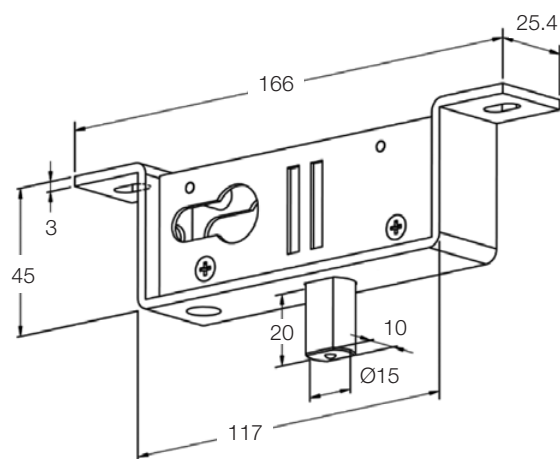

GGHPM88 Euro-Profile Key Cylinder

Available Length : 60 mm

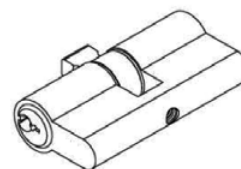

GGHPM88T Thumb Turn & Key Cylinder

Available Length : 60 mm

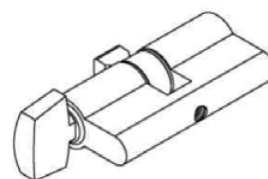

DRMY590CCSC Lock (key-key)

DRMY590CTSC Lock (key-thumb turn)

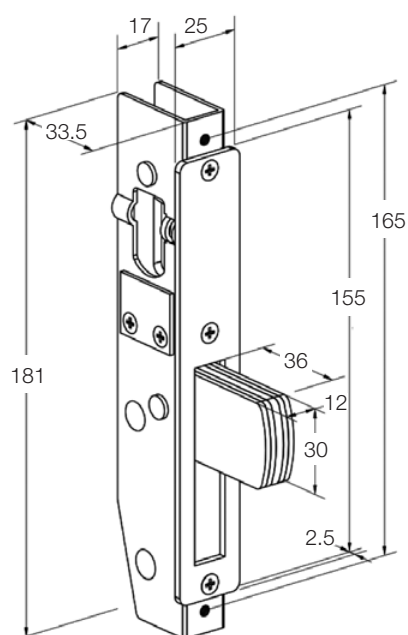

DRMHMT 590 Keeper Plate

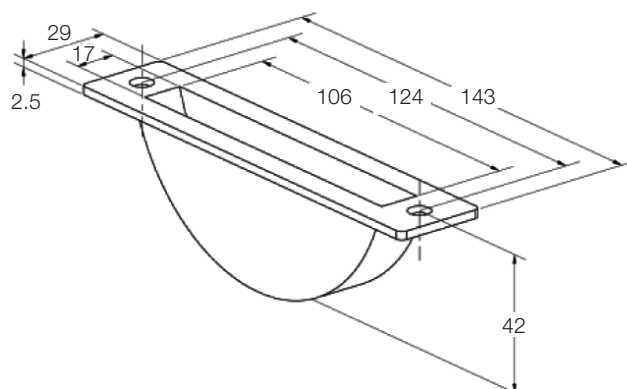

BOTTOM RAIL ACCESSORIES

DRM9123L Door Strap

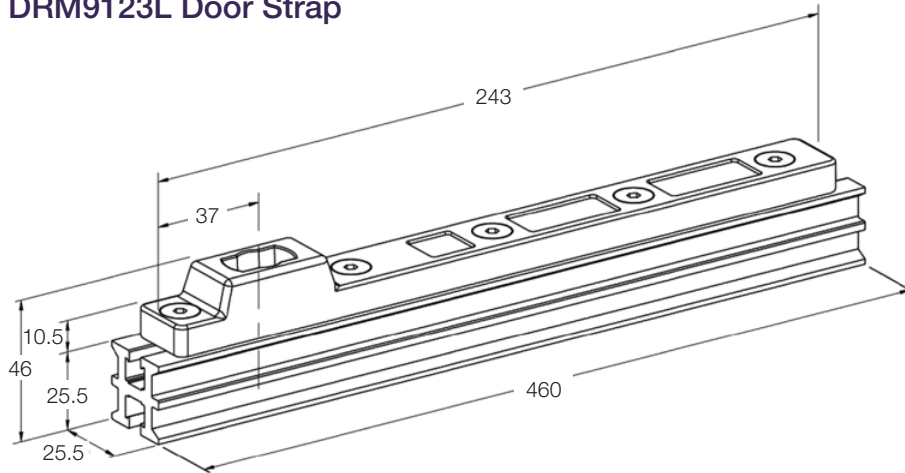

GGH9001WS Drop Bolt Keeper with Cover

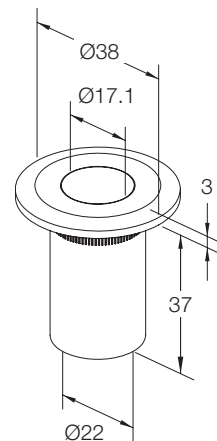

GGHPD15 Floor Pivot

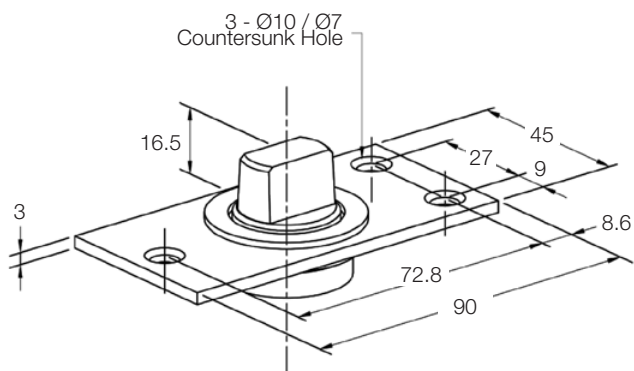

GGH9002 Eccentric Cup

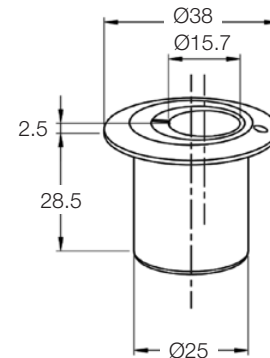

GGH9137 Stainless Steel Keeper Cup

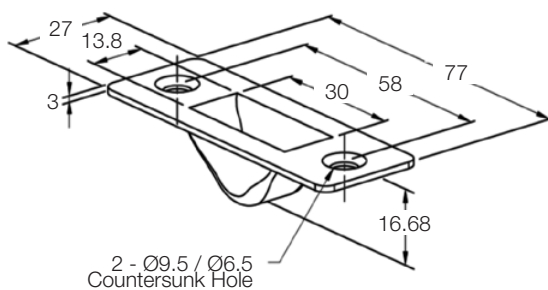

1NT402 Floor Mounted Bottom Free-Swinging Pivot

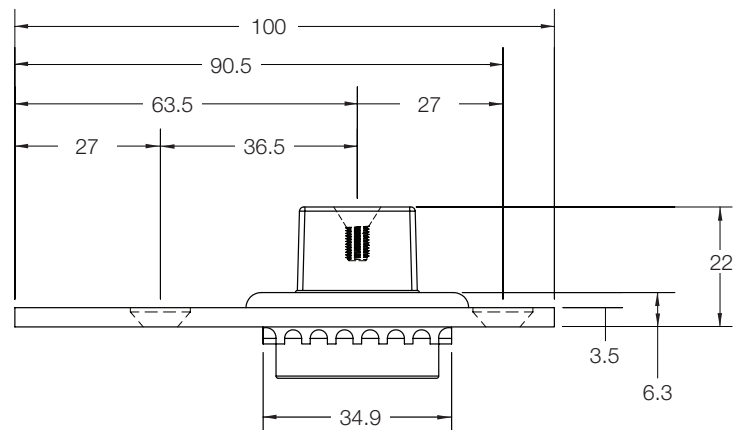

SIDELITE RAILS

Rail for Fixed Panel is Designed To:

- Facilitate ease of installation of fixed glass panel
- Eliminate embedding work for fixed glass panel
- Complement the aesthetic facade of fixed glass panel

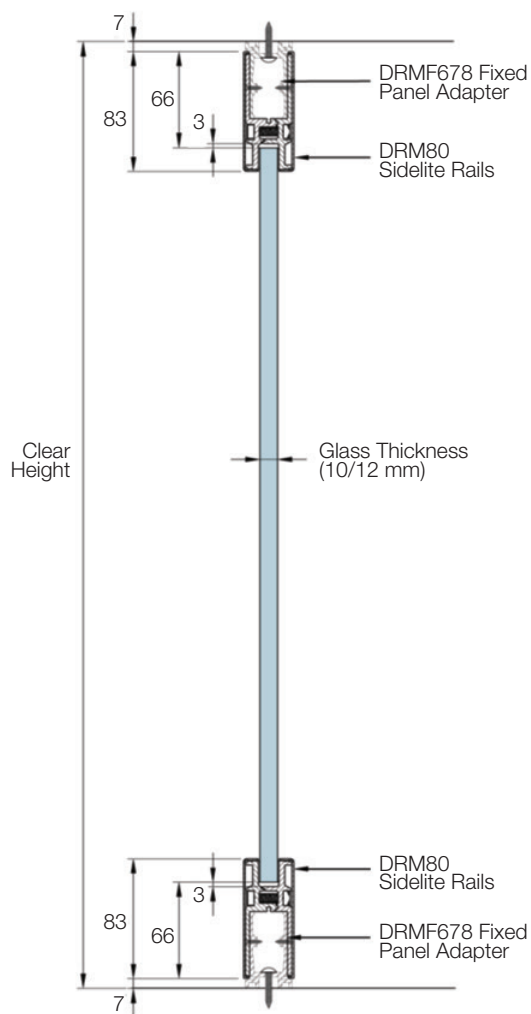

DRM80 Fixed Panel Rails

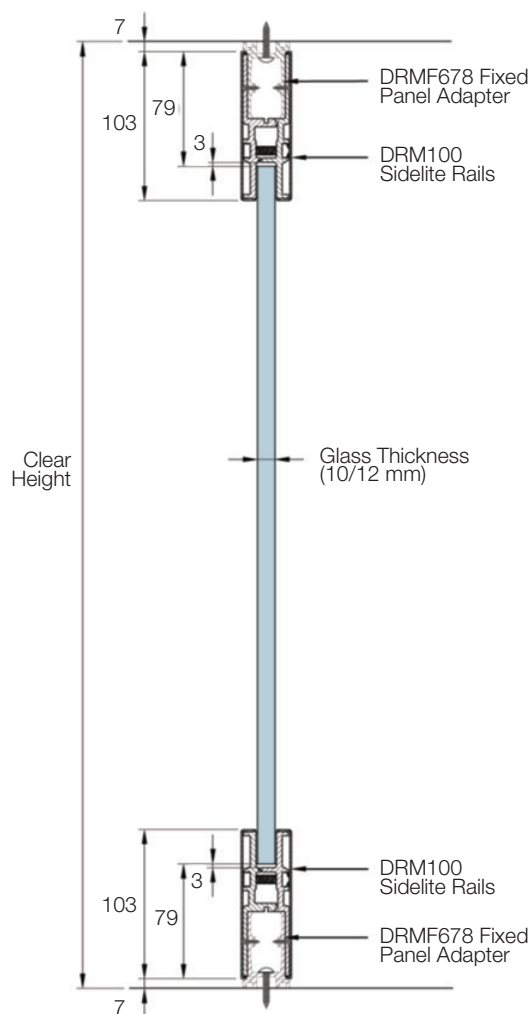

DRM100 Fixed Panel Rails

SLF300

The SLF300 Slide and Stack Glass Panel System features a comprehensive combination of aluminium top track that facilitates flexibility in design layout. This system is able to carry frameless glass door panels of up to 4000 mm in height and width of up to 1100 mm.

With its robust carriage roller made up of a stainless steel body with eight ball bearing wheels, it allows better weight distribution and stability, thereby eliminating excessive swaying and reducing the track to wheel friction thus translating to a smooth and effortless sliding motion.

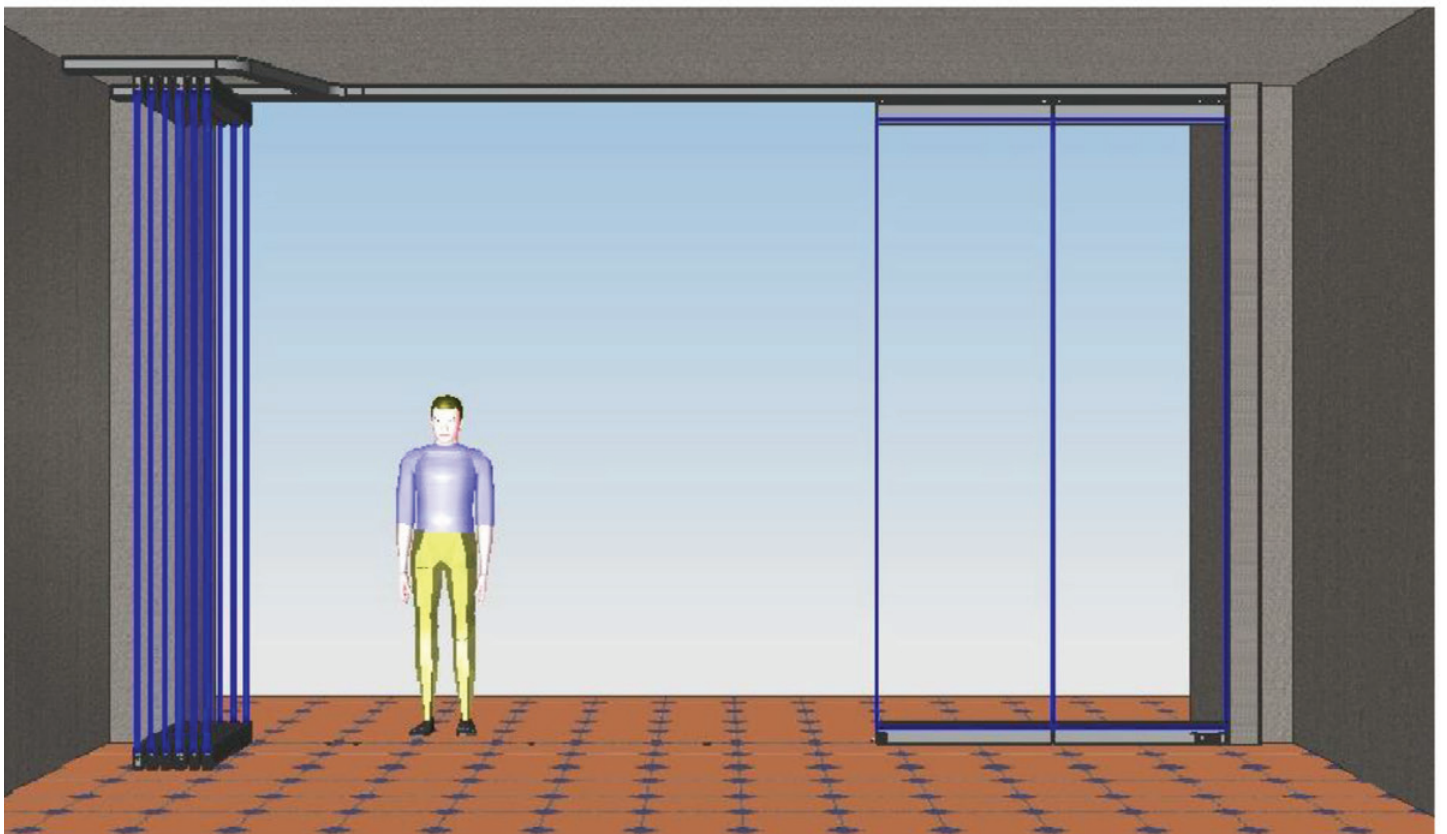
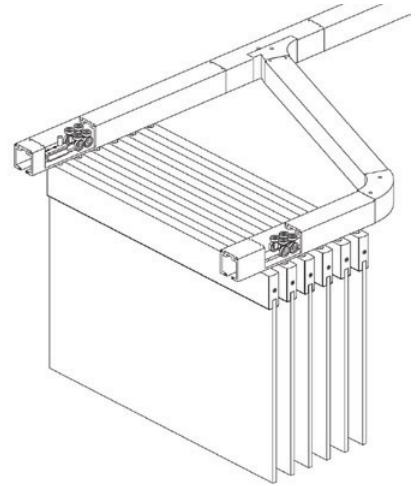

CROSS SECTION (INTERMEDIATE PANELS) WITH DRM80 RAILS

SLF300 with DRM80 Rails is available with the following components:

- Main Top Tracks
- Sliding Door Panel Comprising of:
DRM80 Top & Bottom Rails (1 set/panel)
8pt Carriage Rollers (2nos/panel)
Rubber Seal/Bristle
Flush Bolts
End Caps
Bolt Keepers
- Pivot Door Panel Comprising of:
DRM80 Top & Bottom Rails (1 set/panel)
Top Pivot/End Stopper
Bottom Pivot
Rubber Seal/Bristle
Euro-profile Key/Thumb Turn Cylinders
Lock Bolt
End Caps
Bolt Keepers
- Parking Bay Comprising of:
Junction Track (90°/110°)
Elbow Track (90°/110°)

When placing an order, please specify the following:

- **Length of Rails**
(Glass Panel Width is Required)
- **Door Rails Cover**
Snap-on Aluminium Cover:
Brushed Aluminium Finish
Satin Anodised Finish
- **Glass Thickness**
(10/12 mm)
- **Key Combinations**
Independent - Supplied as standard
Keyed Alike - Available on request

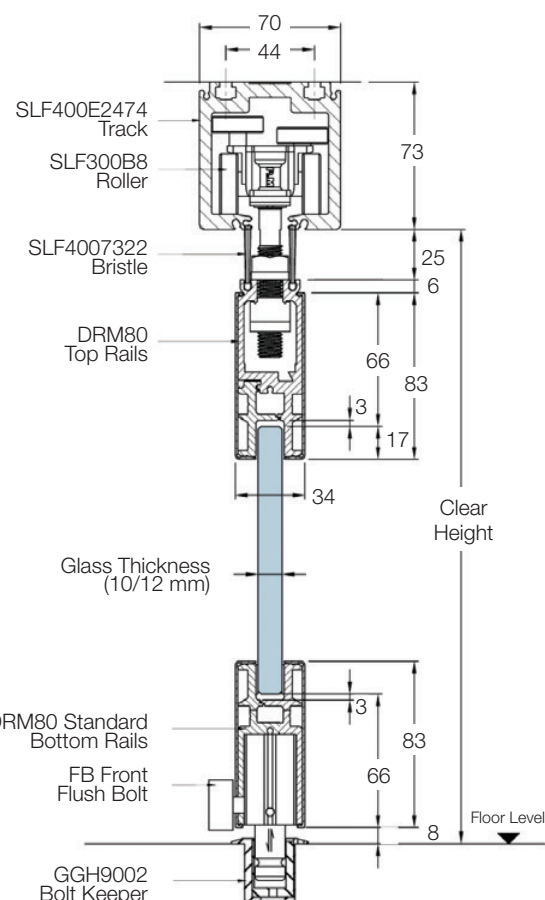
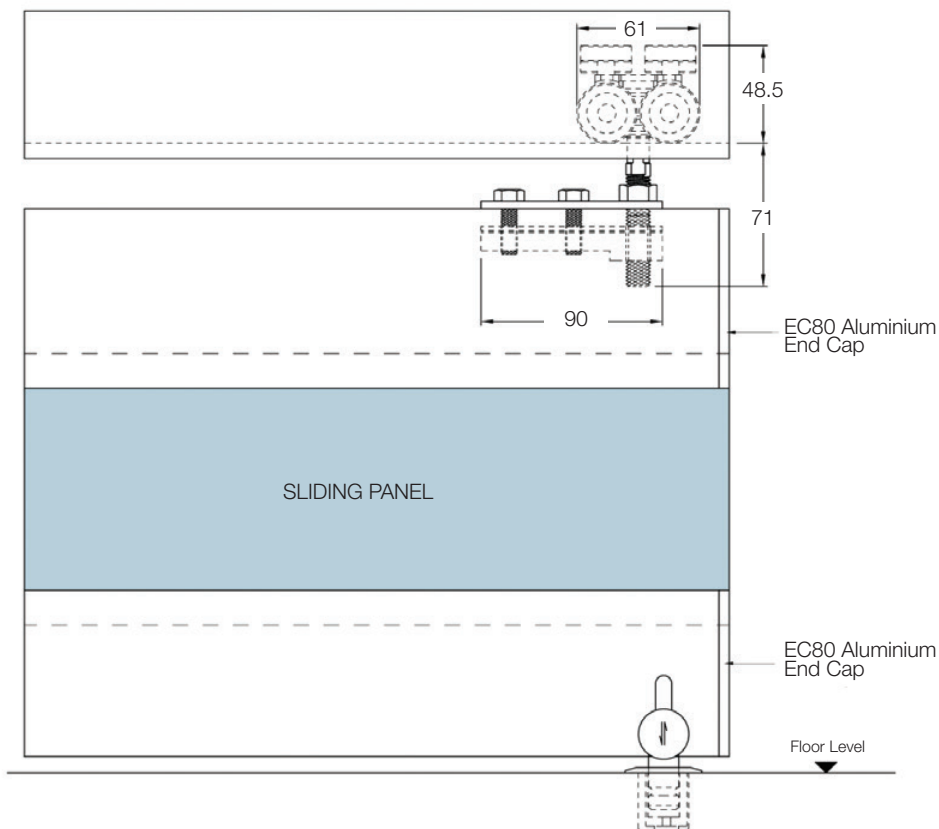

CROSS SECTION (INTERMEDIATE PANELS) WITH DRM100 RAILS

SLF300 with DRM100 Rails is available with the following components:

- Main Top Tracks
- Sliding Door Panel Comprising of:
DRM100 Top & Bottom Rails (1 set/panel)
8pt Carriage Rollers (2nos/panel)
Rubber Seal/Bristle
Flush Bolts
End Caps
Bolt Keepers
- Pivot Door Panel Comprising of:
DRM100 Top & Bottom Rails (1 set/panel)
Top Pivot/End Stopper
Bottom Pivot
Rubber Seal/Bristle
Euro-profile Key/Thumb Turn Cylinders
Lock Bolt
End Caps
Bolt Keepers
- Parking Bay Comprising of:
Junction Track (90°/110°)
Elbow Track (90°/110°)

When placing an order, please specify the following:

- **Length of Rails**
(Glass Panel Width is Required)
- **Door Rails Cover**
Snap-on Aluminium Cover:
Brushed Aluminium Finish
Satin Anodised Finish
- **Glass Thickness**
(10/12 mm)
- **Key Combinations**
Independent - Supplied as standard
Keyed Alike - Available on request

NOTE:

- Glass thru-hole fixing is recommended for door panels with ≥ 3 m height.

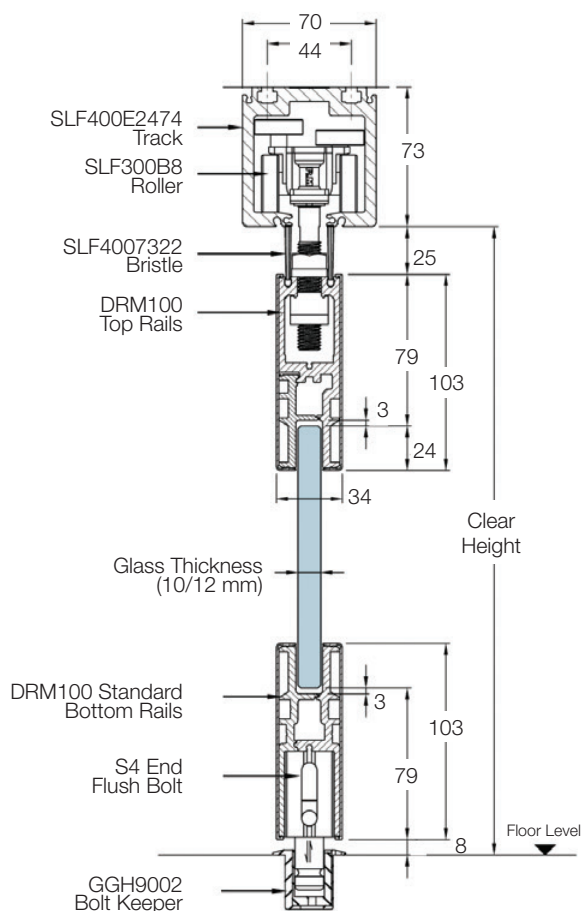
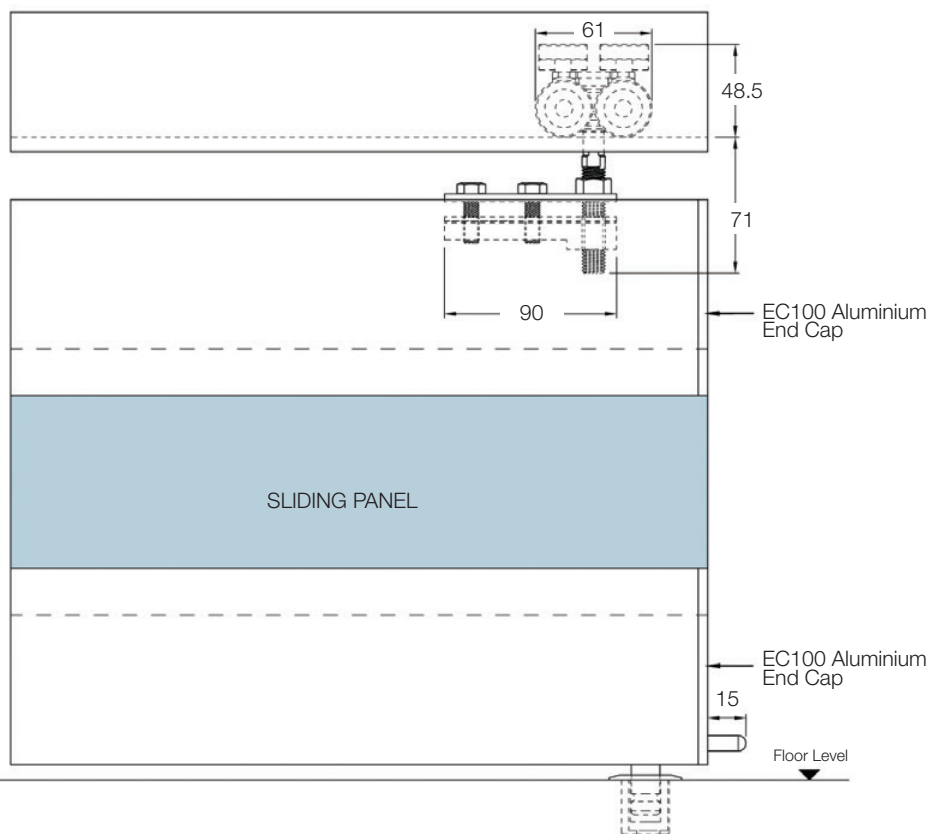

SLIDE AND STACK GLASS PANEL SYSTEM

PLAN VIEW OF PARKING BAY

Layout 1

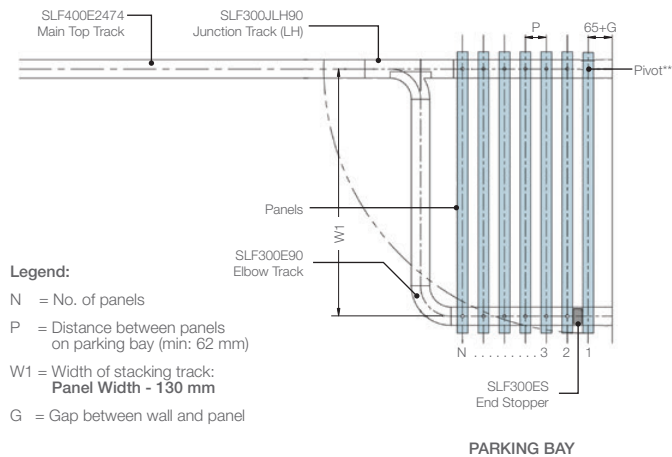

Layout 2

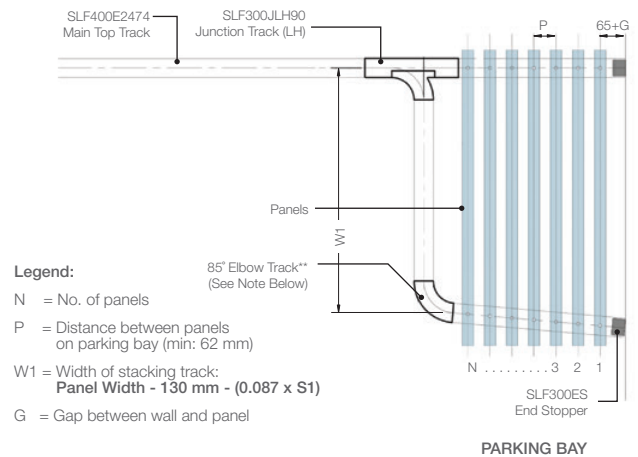

Layout 3

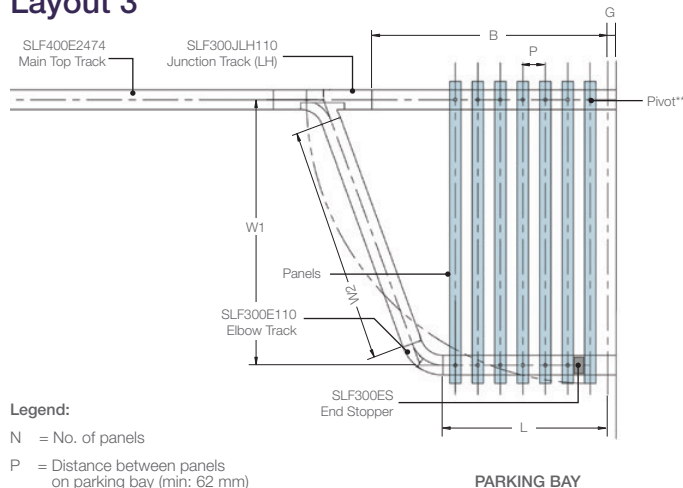

Layout 4

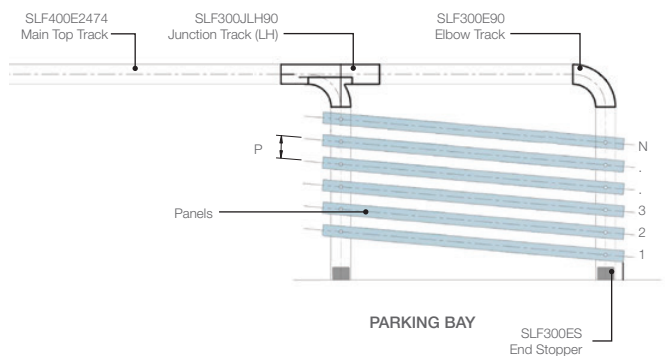

Layout 5

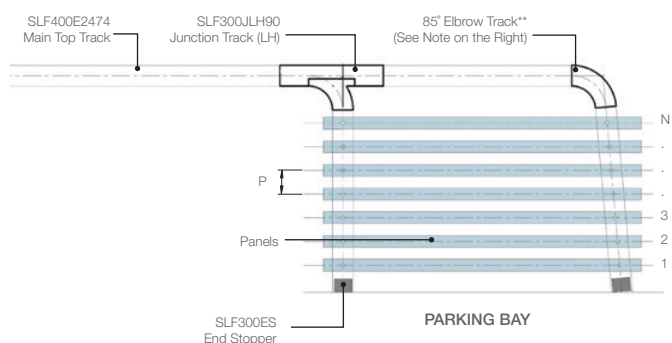

ALUMINIUM TOP TRACK

SLF300JLH90
90° Left Hand Junction

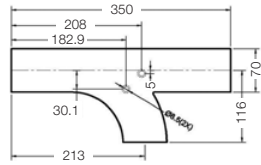
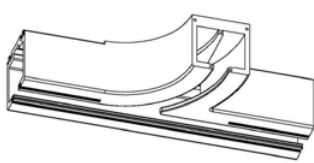

SLF300JRH90
90° Right Hand Junction

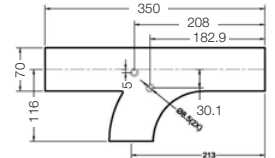
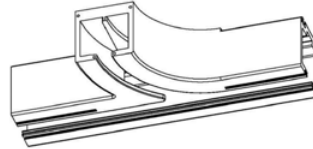

SLF300JLH110
110° Left Hand Junction

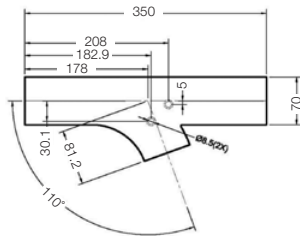
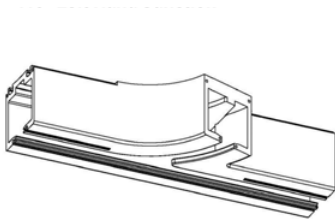

SLF300JRH110
110° Right Hand Junction

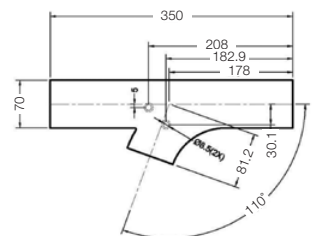
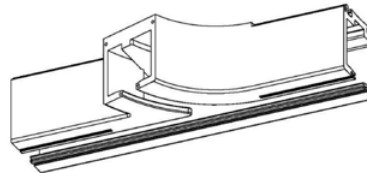

SLF300E90 90° Elbow

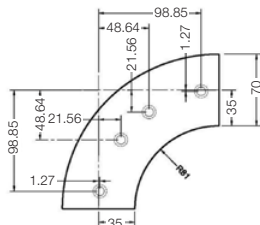
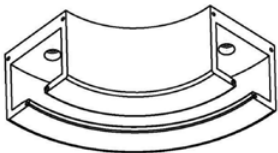

SLF300E110 110° Elbow

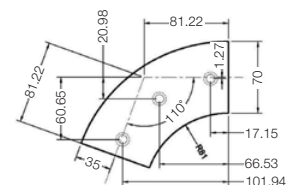
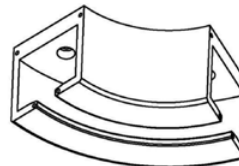

SLF300T3
T-Junction

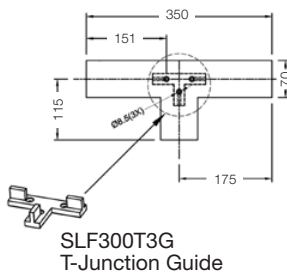

SLF300T90
Corner Junction

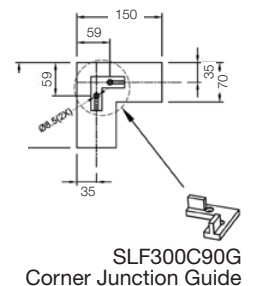
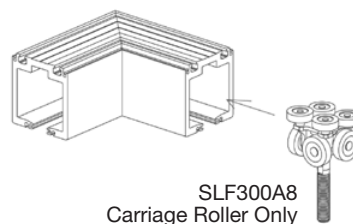

ACCESSORIES

SLF400E2474
Main Top Track

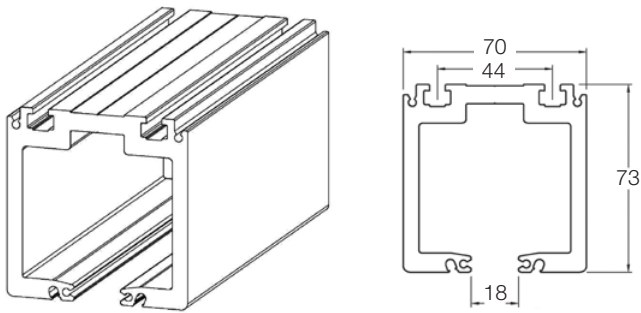

SLF300A8
8pt Carriage
Roller with
Slider



SLF300B8
8pt Carriage Roller
with Slider

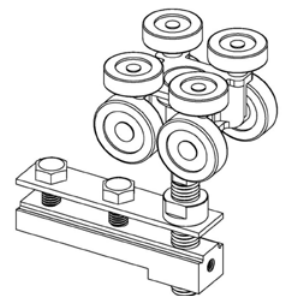

TOP ACCESSORIES AND END CAPS

End Cap

EC80

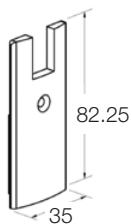

EC100



SLF300ECH80
End Cap
With Hole

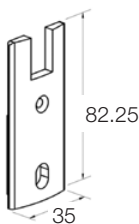

SLF300ECH100
End Cap
With Hole



SLF300ECS80
Slotted End Cap

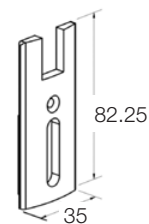

SLF300ECS100
Slotted End Cap

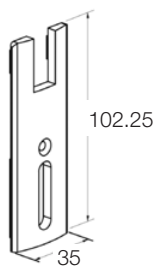

SLF4007300 Rubber Seal
Length: 3050 mm

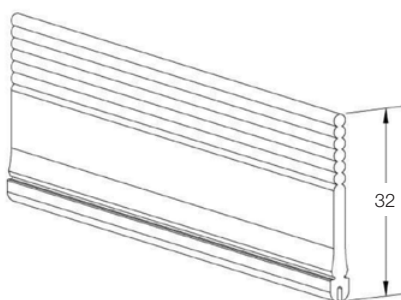

SLF4007322 Bristle
Length: 1000 mm

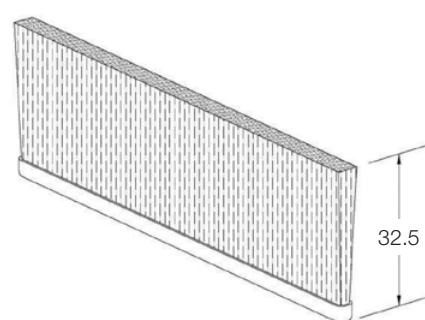

SLF400TP
Top Pivot with Slider

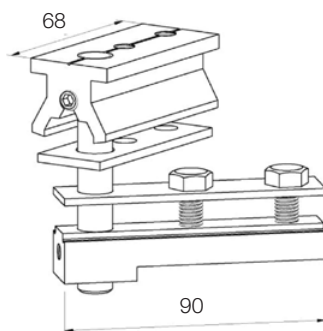

SLF300ES
End Stopper

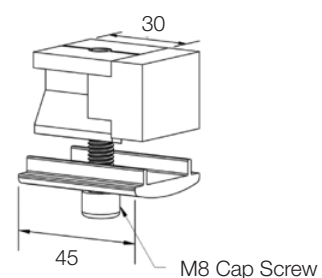

BOTTOM ACCESSORIES

SLF300S4
End Flush Bolt

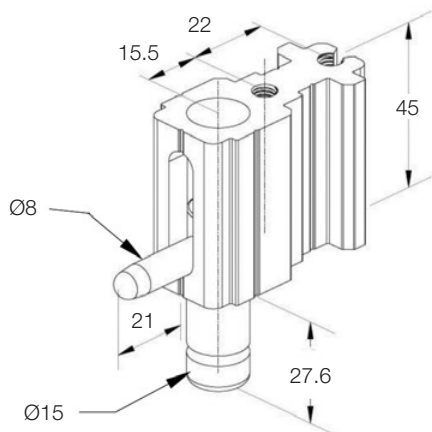

SLF400FB
Front Flush Bolt

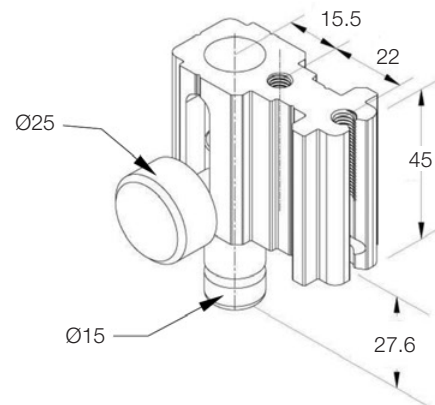

PL2 - Lock Bolt

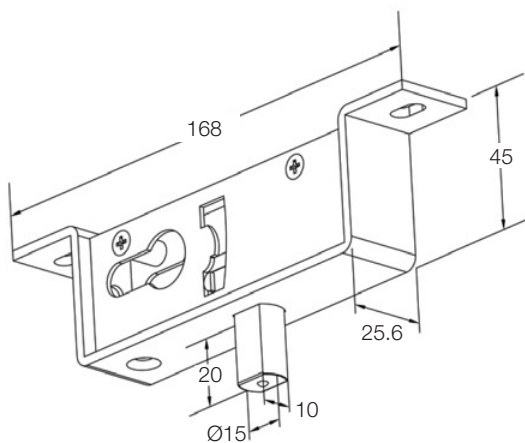

GGHPD16
Bottom Pivot

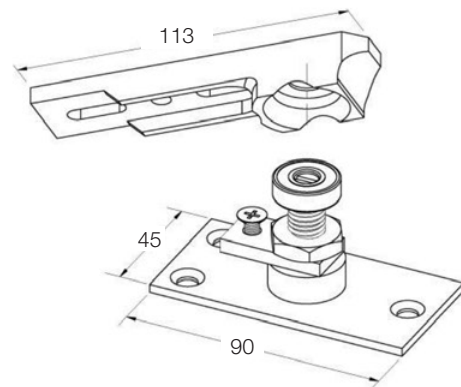

PM88 - Euro-Profile
Key Cylinder
Length: 60 mm

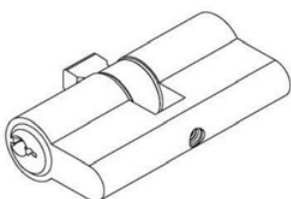

PM88T - Thumb Turn & Key Cylinder
Length: 60 mm
(28 mm thumb turn only)

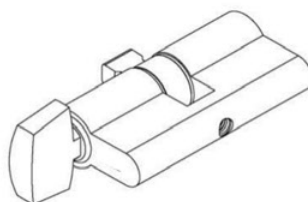

GGH9002 - Eccentric Bolt Keeper

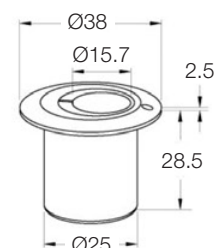

SLF400

The SLF400 Slide and Fold Glass Panel System features a straight sliding aluminium top track. This system is able to carry frameless glass door panels of up to 2700 mm in height and widths of up to 750 mm.

NOTE: Please contact technical sales if panels exceed the stated dimensions. Subject to technical consideration on the maximum number of panels.

With its robust carriage roller made up of stainless steel body with ten ball bearing wheels, it allows better weight distribution and stability, thereby eliminating excessive swaying and reducing the track to wheel friction thus translating to a smooth and effortless sliding motion.

The SLF400 maximises the opening area as the inter-locking frameless glass panels dock in an accordion like manner.

It also enhances maximum security with various security locking devices (key lock; thumb turn lock).

SLF400 comprises of sliding door intermediate panels and swinging door pivot panel. In addition, you have a choice of aluminium clip-on rail covers in brushed aluminium or satin anodised finish.

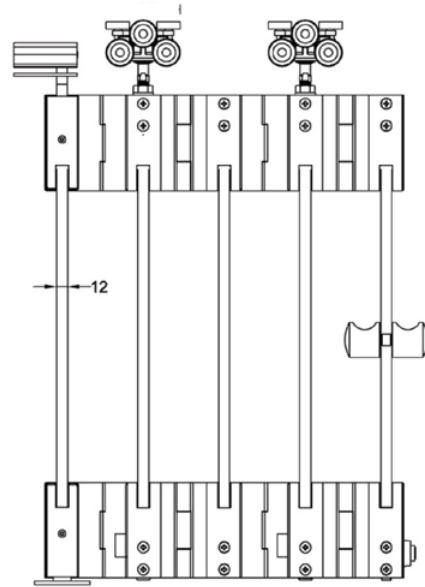

CROSS SECTION (INTERMEDIATE PANELS) WITH DRM80 RAILS

SLF400 with DRM80 Rails is available with the following components:

- Main Top Tracks
- Sliding Door Panel Comprising of:
 - DRM80 Top & Bottom Rails (1 set/panel)
 - 10pt Carriage Rollers (1no/alternate panel)
 - Hinge
 - Rubber Seal/Bristle
 - Flush Bolts
 - End Caps
 - Bolt Keepers
- Swinging Door Panel Comprising of:
 - DRM80 Top & Bottom Rails (1 set/panel)
 - Hinge
 - Top Pivot/End Stopper
 - Bottom Pivot
 - Rubber Seal/Bristle
 - Euro-profile Key/Thumb Turn Cylinders
 - Lock Bolt
 - End Caps
 - Bolt Keepers

When placing an order, please specify the following:

- **Length of Rails**
(Glass Panel Width is Required)
- **Door Rails Cover**
Snap-on Aluminium Cover:
Brushed Aluminium Finish
Satin Anodised Finish
- **Glass Thickness**
(10/12 mm)
- **Key Combinations**
Independent - Supplied as standard
Keyed Alike - Available on request

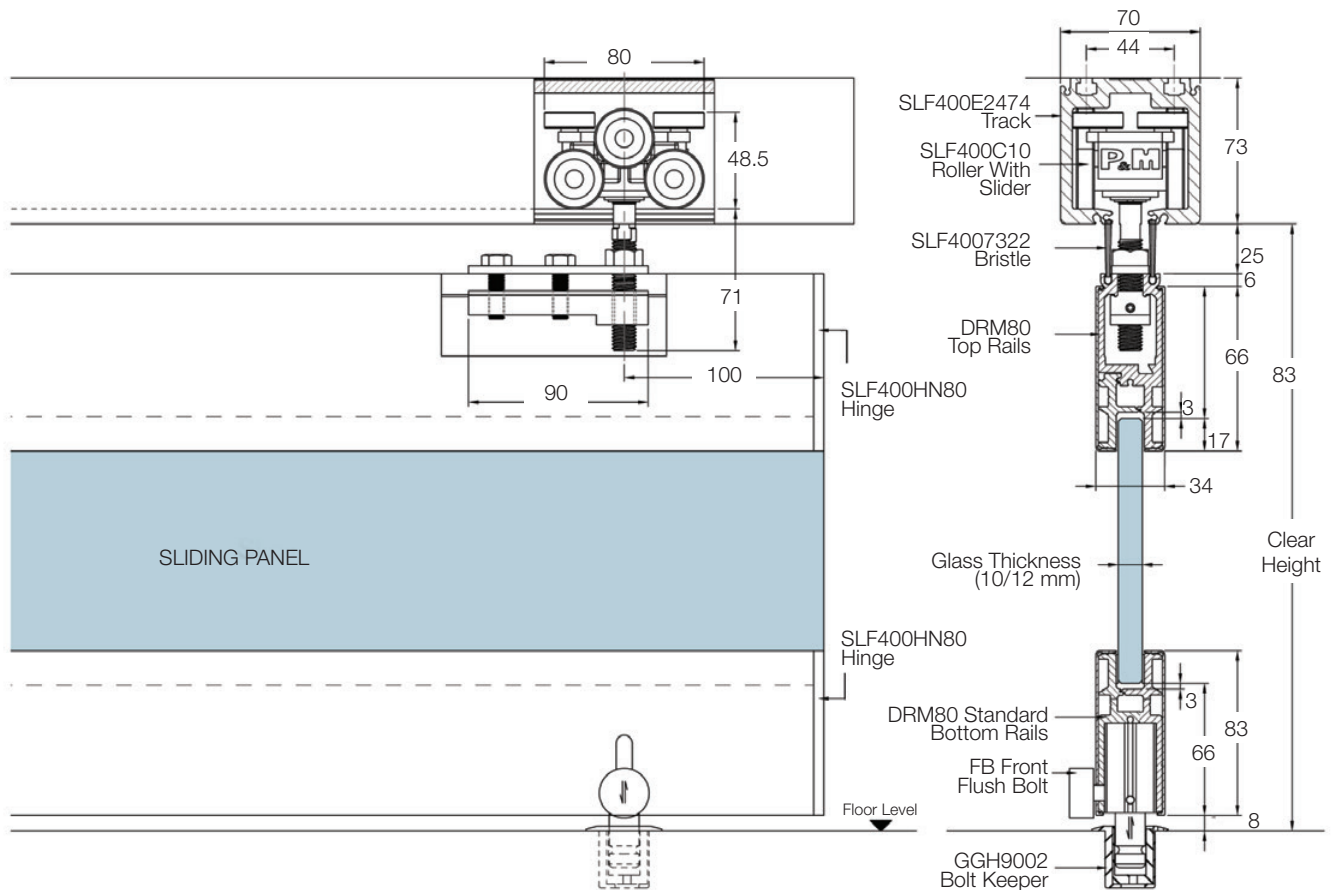

** Glass Height = Clear Height - (97 + 74)

CROSS SECTION (INTERMEDIATE PANELS) WITH DRM100 RAILS

SLF400 with DRM100 Rails is available
with the following components:

- Main Top Tracks
- Sliding Door Panel Comprising of:
DRM100 Top & Bottom Rails (1 set/panel)
10pt Carriage Rollers (1no/alternate panel)
Rubber Seal/Bristle
Flush Bolts
End Caps
Bolt Keepers
- Swinging Door Panel Comprising of:
DRM100 Top & Bottom Rails (1 set/panel)
Hinge
Top Pivot/End Stopper
Bottom Pivot
Rubber Seal/Bristle
Euro-profile Key/Thumb Turn Cylinders
Lock Bolt
End Caps
Bolt Keepers

When placing an order,
please specify the following:

- Length of Rails
(Glass Panel Width is Required)
- Door Rails Cover
Snap-on Aluminium Cover:
Brushed Aluminium Finish
Satin Anodised Finish
- Glass Thickness
(10/12 mm)
- Key Combinations
Independent - Supplied as standard
Keyed Alike - Available on request

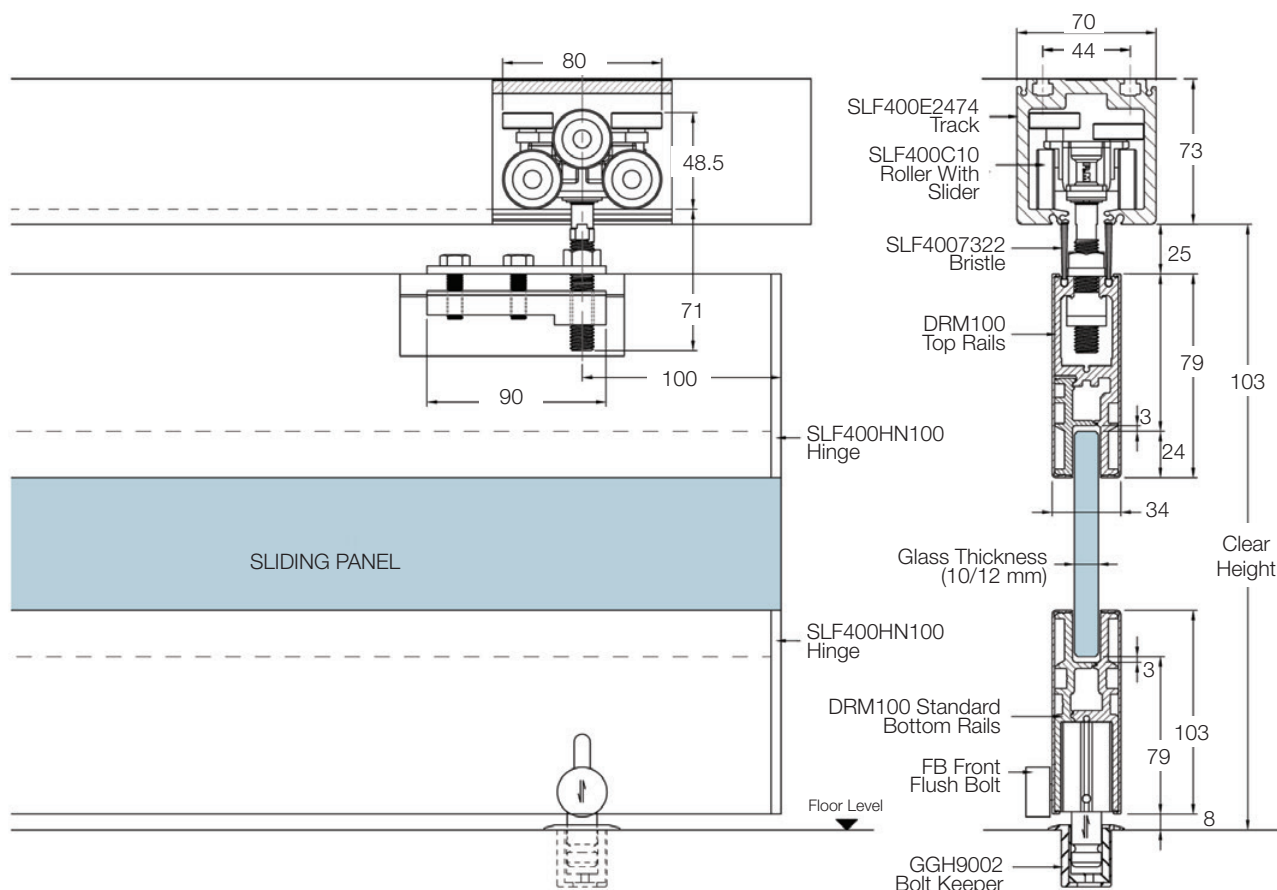

** Glass Height = Clear Height - (104 + 87)

PLAN VIEW OF PARKING SPACE

Plan View

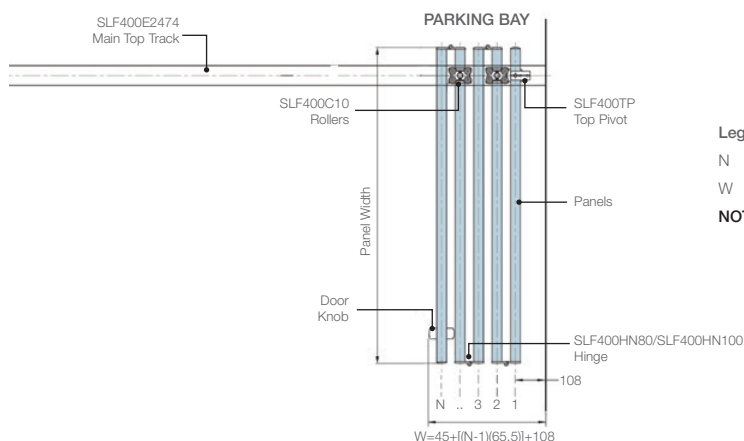

Legend:

N = No. of panels

W = Width of space for folded panels

NOTE: Pivot is on the 1st panel.

ACCESSORIES

SLF400E2474
Main Top Track

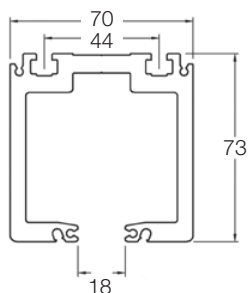
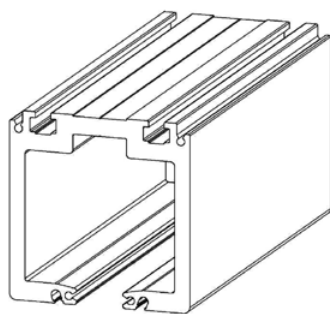

SLF400C10
10pt Carriage Roller
with Slider

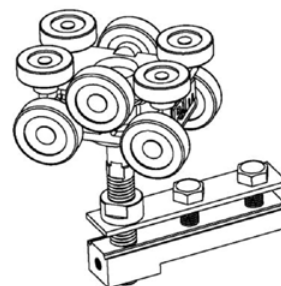

SLF4007300 Rubber Seal
Length: 3050 mm

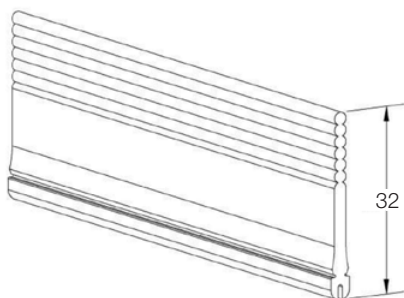

SLF4007322 Bristle
Length: 1000 mm

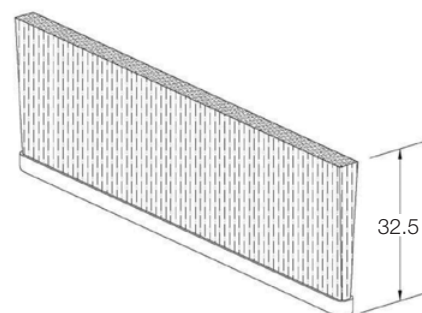

SLF400TP Top Pivot with Slider

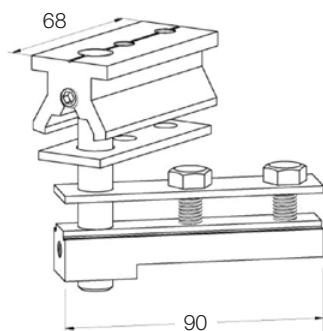

GGHPD16 Bottom Pivot

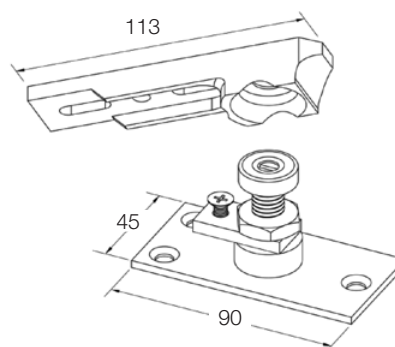

ACCESSORIES

**SLF400HN80
Hinge (DRM80)**

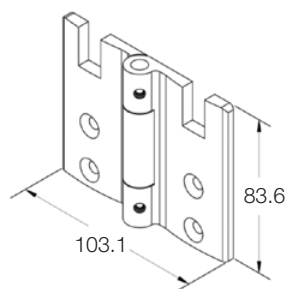

**SLF400HN100
Hinge (DRM100)**

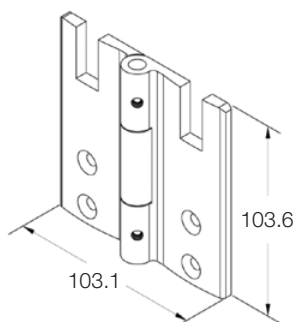

**Glass Gap Between Folding Hinge
(SLF400HN80/SLF400HN100)**

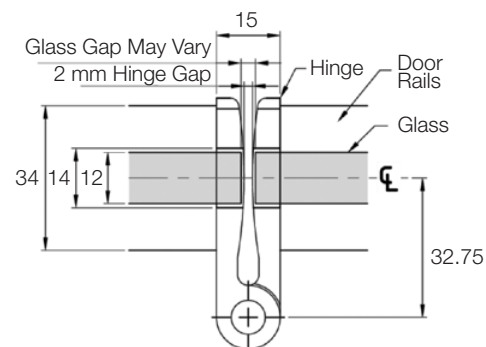

SLF400HN810 Bracket

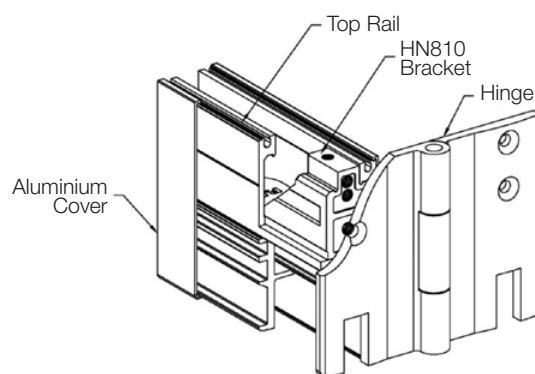
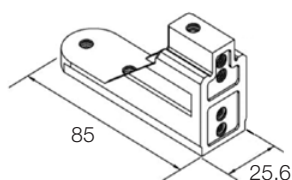

End Cap

EC80

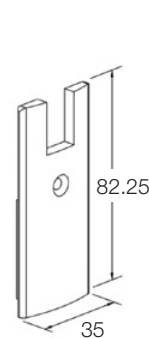

EC100

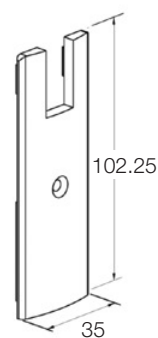

**SLF400FB
Front Flush Bolt**

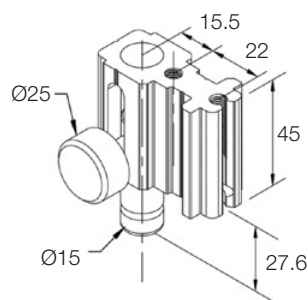

PL2 - Lock Bolt

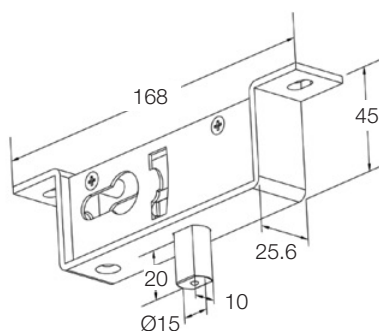

**PM88 - Euro-Profile Key
Cylinder**

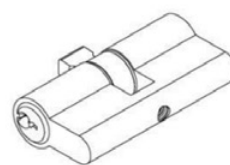

**PM88T - Thumb Turn &
Key Cylinder**

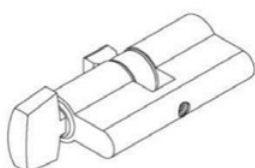

**GGH9002 - Eccentric
Bolt Keeper**

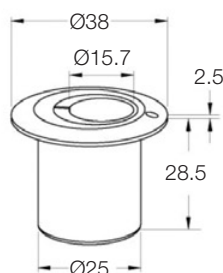

CRL LADDER PULLS & PULL HANDLES

CRL Straight Style Ladder Pulls

- Up to Eleven Sizes in Two Stainless Finishes Plus New Matte Black
- Extra Height for Eye-Catching Contemporary and Elegant Appearance
- For 3/8" to 3/4" (10 to 19 mm) Tempered Glass or 1-3/4" (44 mm) Aluminium Doors
- 1-1/4" (32 mm) Diameter Heavy Wall 304 Grade Stainless Steel Tubing
- Custom Finishes and Sizes Available



Made of Durable 1-1/4" (32 mm) Diameter 304 Grade Polished or Brushed Stainless Steel Tubing

CODE	OVERALL LENGTH	MOUNTING HOLE CENTRE	DESCRIPTION
24LPBS	610 mm	305 mm	CRL Grade 304 Stainless T Style Handle Brushed
24LPSS	610 mm	305 mm	CRL Grade 304 Stainless T Style Handle Polished
24LPMBL	610 mm	305 mm	CRL Grade 304 Stainless T Style Handle Matte Black
36LPBS	914 mm	610 mm	CRL Grade 304 Stainless T Style Handle Brushed
36LPSS	914 mm	610 mm	CRL Grade 304 Stainless T Style Handle Polished
36LPMBL	914 mm	610 mm	CRL Grade 304 Stainless T Style Handle Matte Black
42LPBS	1067 mm	762 mm	CRL Grade 304 Stainless T Style Handle Brushed
42LPSS	1067 mm	762 mm	CRL Grade 304 Stainless T Style Handle Polished
42LPMBL	1067 mm	762 mm	CRL Grade 304 Stainless T Style Handle Matte Black
48LPBS	1219 mm	914 mm	CRL Grade 304 Stainless T Style Handle Brushed
48LPSS	1219 mm	914 mm	CRL Grade 304 Stainless T Style Handle Polished
48LPMBL	1219 mm	914 mm	CRL Grade 304 Stainless T Style Handle Matte Black
60LPBS	1524 mm	1219 mm	CRL Grade 304 Stainless T Style Handle Brushed
60LPSS	1524 mm	1219 mm	CRL Grade 304 Stainless T Style Handle Polished
60LPMBL	1524 mm	1219 mm	CRL Grade 304 Stainless T Style Handle Matte Black
72LPBS	1829 mm	1524 mm	CRL Grade 304 Stainless T Style Handle Brushed
72LPSS	1829 mm	1524 mm	CRL Grade 304 Stainless T Style Handle Polished
72LPMBL	1829 mm	1524 mm	CRL Grade 304 Stainless T Style Handle Matte Black
84LPBS	2134 mm	1829 mm	CRL Grade 304 Stainless T Style Handle Brushed
84LPSS	2134 mm	1829 mm	CRL Grade 304 Stainless T Style Handle Polished
84LPMBL	2134 mm	1829 mm	CRL Grade 304 Stainless T Style Handle Matte Black



CRL Glass Mounted Square Tube Style Back-to-Back Pull Handle

- For 3/8" to 3/4" (10 to 19 mm) Glass
- Extra Bolts Available, Sold Separately
- Available in Several Sizes and Finishes
- Use Monolithic Tempered Glass

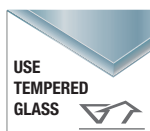

CODE	MOUNTING HOLE CENTRE	DESCRIPTION
SQ10X10BS	254 mm	CRL Glass Mounted Square Back to Back Handle Brushed
SQ10X10PS	254 mm	CRL Glass Mounted Square Back to Back Handle Polished
SQ10X10MBL	254 mm	CRL Glass Mounted Square Back to Back Handle Matte Black
SQ18X18BS	457 mm	CRL Glass Mounted Square Back to Back Handle Brushed
SQ18X18PS	457 mm	CRL Glass Mounted Square Back to Back Handle Polished
SQ18X18MBL	457 mm	CRL Glass Mounted Square Back to Back Handle Matte Black
SQ24X24BS	610 mm	CRL Glass Mounted Square Back to Back Handle Brushed
SQ24X24PS	610 mm	CRL Glass Mounted Square Back to Back Handle Polished
SQ24X24MBL	610 mm	CRL Glass Mounted Square Back to Back Handle Matte Black

CRL Straight and Offset Back-to-Back Pull Handles

- Stocked in Up to Five Architectural Finishes
- For Use With 3/8" to 3/4" (10 to 19 mm) Tempered Glass
- Complete With Matching Finish Metal Washers and Through-Bolts for Mounting



CODE	MOUNTING HOLE CENTRE	DESCRIPTION
CM10X10BS	254 mm	CRL Straight Back to Back Pull Handle Brushed
CM10X10PS	254 mm	CRL Straight Back to Back Pull Handle Polished
CM12X12BS	305 mm	CRL Straight Back to Back Pull Handle Brushed
CM12X12PS	305 mm	CRL Straight Back to Back Pull Handle Polished

CRL GLASS MOUNTED LATCHES & LEVER HANDLES

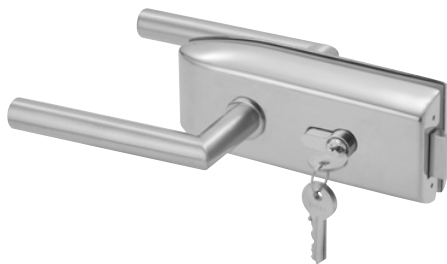

CRL Glass Mounted Latch

- Works on Single or Double Doors
- For 3/8" or 1/2" (10 or 12 mm) Tempered Glass
- Field Reversible
- Quiet Closing
- Lever Handles Not Included - See Below



Included



CODE	DESCRIPTION
PTH311BS	CRL Glass Mounted Latch w/ Lock and Thumbturn Brushed Stainless
PTH311A	CRL Glass Mounted Latch w/ Lock and Thumbturn Clear Anodised
PTH311PS	CRL Glass Mounted Latch w/ Lock and Thumbturn Polished Stainless



CRL Glass Mounted Passage Latch

- Works on Single or Double Doors
- For 3/8" or 1/2" (10 or 12 mm) Monolithic Tempered Glass
- 304 Grade Stainless Steel
- Use Monolithic Tempered Glass
- Lever Handles Not Included - See Below



Included



CODE	DESCRIPTION
PTH312BS	CRL Glass Mounted Passage Latch Brushed Stainless
PTH312A	CRL Glass Mounted Passage Latch Clear Anodised
PTH312PS	CRL Glass Mounted Passage Latch Polished Stainless



CRL Glass Mounted Latch Keeper

- For 3/8" or 1/2" (10 or 12 mm) Monolithic Tempered Glass
- Stamped Body with Finished Cover Plates
- Works with Either Latch Above on Double Doors



CODE	DESCRIPTION
PTH314BS	CRL PTH Glass Mounted Keeper Brushed Stainless
PTH314A	CRL PTH Glass Mounted Keeper Clear Anodised
PTH314PS	CRL PTH Glass Mounted Keeper Polished Stainless



CRL Sculptured Style Lever Handles

- For Use with PTH311 and PTH312 Glass Mounted Latch Mechanisms
- Available in Two Finishes
- Includes: Hex Wrench

CODE	DESCRIPTION
PTH303BS	CRL Extended Keyed Cylinder Brushed Stainless
PTH303PS	CRL Extended Keyed Cylinder Polished Stainless



CRL Tubular Style Lever Handles

- For Use with PTH311 and PTH312 Glass Mounted Latch Mechanisms
- Available in Three Finishes
- Includes: Hex Wrench

CODE	DESCRIPTION
PTH302BS	CRL PTH Tubular Style Lever Handle Brushed Stainless
PTH302A	CRL PTH Tubular Style Lever Handle Clear Anodised
PTH302PS	CRL PTH Tubular Style Lever Handle Polished Stainless

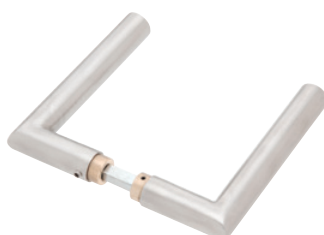

CRL Modern Style Lever Handles

- For Use with PTH311 and PTH312 Glass Mounted Latch Mechanisms
- Available in Two Finishes
- Includes: Hex Wrench

CODE	DESCRIPTION
PTH306BS	CRL PTH Modern Style Lever Handle Brushed Stainless
PTH306PS	CRL PTH Modern Style Lever Handle Polished Stainless

CRL OVERHEAD CONCEALED DOOR CLOSERS FOR PATCH FITTINGS AND DOOR RAILS

- Interchangeable with All Jackson® Style Overhead Concealed Door Closers
- Extended 3/4" (19 mm) Long Spindle for Use with Patch Fittings and Door Rail Hardware

- Conveniently Packaged With Templates and Instructions
- For Doors Weighing Under 200 Pounds (91 kg)
- 5 Year Limited Warranty
- UL Listed



A.D.A. Compliance
Models Available



Extended Length Spindle
3/4" (19 mm) Length Spindle
for use with Patch Fittings and
Door Rail Hardware or when extra
reach is needed.

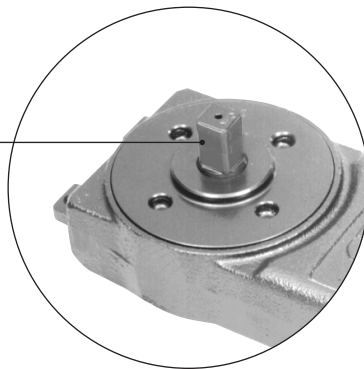

CODE	DESCRIPTION
CRL9160	90 Degree Medium Hold Open
CRL9162	90 Degree Medium No Hold Open
CRL9170	105 Degree Medium Hold Open
CRL9172	105 Degree Medium No Hold Open
CRL9260	90 Degree Heavy Hold Open
CRL9262	90 Degree Heavy No Hold Open
CRL9270	105 Degree Heavy Hold Open
CRL9272	105 Degree Heavy No Hold Open
CRL9760	90 Degree Adjustable Spring Hold Open
CRL9762	90 Degree Adjustable Spring No Hold Open
CRL9770	105 Degree Adjustable Spring Hold Open
CRL9772	105 Degree Adjustable Spring No Hold Open
CRL9970	105 Degree Hold Open A.D.A. Compliant
CRL9972	105 Degree Hold Open A.D.A. Compliant



Typical Installation Showing Exposed
Spindle of Overhead Closer

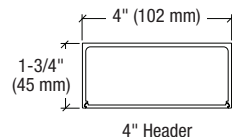

CRL 914 mm Single Door Header

- Includes A Snap-In Cover Plates With All Door Closer Fabrication Completed
- Available in Six Architectural Finishes
- Ready to Ship fro CRL Inventory

CODE	DESCRIPTION
DCH4SAS	914 mm Header Kit Satin Anodised
DCH4BSS	914 mm Header Kit Brushed Stainless

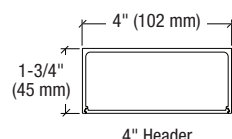
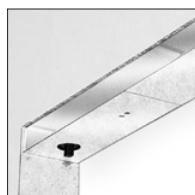

CRL 1829 mm Single Door Header

- Standard 102, 114, and 152 mm sizes
- Custom Sizes Available on Special Order

CODE	DESCRIPTION
DCH4SAD	1829 mm Header Kit Satin Anodised
DCH4BSD	1829 mm Header Kit Brushed Stainless

CRL OVERHEAD CONCEALED DOOR CLOSERS AND HEADERS

CRL FLOOR MOUNTED DOOR CLOSERS



CRL 8300 Series Shallow Depth Floor Mounted Door Closers

- 264 Pound (120 kg) Capacity, for Doors Up to 42" (1067 mm) Wide
- Low Profile 1-9/16" (40 mm) Depth
- Interchangeable Spindle Heights
- 5 Year Limited Warranty
- UL Listed

CODE	DESCRIPTION
CRL8360	90 Degree Hold Open Medium Duty Low Profile
CRL8370	105 Degree Hold Open Medium Duty Low Profile
CRL8372	105 Degree Non Hold Open Medium Duty Low Profile

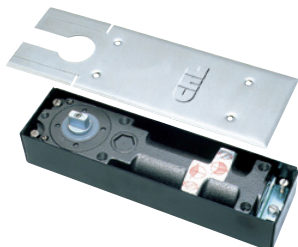

CRL8400 Series Narrow Width Floor Mounted Door Closers

- The Perfect Door Closer to Support CRL's Patch Hardware
- 264 Pound (120 kg) Capacity, for Doors Up to 42" (1067 mm) Wide
- Narrow 3-1/16" (78 mm) Width
- Interchangeable Spindle Heights
- 5 Year Limited Warranty
- UL Listed

CODE	DESCRIPTION
CRL8460	Hold Open Medium Duty Narrow Floor Mounted
CRL8462	Non Hold Open Medium Duty Narrow Floor Mounted



CRL8500 Series Heavy Weight Floor Mounted Door Closers

- The Perfect Door Closer to Support CRL's Door Rail System
- 800 Pound (363 Kg) Capacity, for Doors Up to 54" (1.37 m) Wide
- Interchangeable Spindle Heights
- Independent Closing and Latching Speed Adjustments
- 5 Year Limited Warranty
- UL Listed

CODE	DESCRIPTION
CRL8542	180 Degree Non Hold Open Size 4 Spring Heavy-Duty
CRL8544	90 Degree Hold Open Size 4 Spring Heavy-Duty
CRL8546	105 Degree Hold Open Size 4 Spring Heavy-Duty



Basic Closer Package

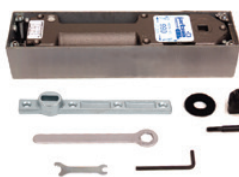

Center-Hung Package

CRL Jackson 900 Series Heavy-Duty Floor Mounted Door Closers

- 1000 Pound (454 kg) Capacity, for Door Up to 54" (1.37 m) Wide
- Multi-Size Adjustable Spring Power
- Interchangeable Spindle Heights
- Leveling and Door Centering Adjustments
- 10 Year Limited Warranty
- UL Listed

BASIC CLOSER PACKAGE CODE	CENTER HUNG PACKAGE CODE	DESCRIPTION
J990NH0D	J990NH0N	Non Hold Open Jackson Package
J9903H0D	J993H0N	90 Degree & 120 Deg Dual Hold Open Jackson Package
J994H0D	J994H0N	105 Degree Hold Open Jackson Closer Package
J995BCD	J995BCN	180 Degree No Hold Open Swingback @ 85 Deg Jackson Package



CRL Floor Mounted Closer Cover Plates

- Fits 900 Series Floor Mounted Door Closers



CODE	DESCRIPTION
J7020CPBS	Jackson Cover Plate Brushed Stainless
J7020CPPS	Jackson Cover Plate Polished Stainless

CRL Interchangeable Floor Closer Spindles

- Fit All CRL8300, CRL8400, and CRL8500 Series Floor Mounted Door Closers



Flat Tapered

CODE	COLLAR HEIGHTS/DRS DOOR CLEARANCE	STANDARD DOOR CLEARANCE
CRL9040S	3 mm	8 mm
CRL6010S8	8 mm	13 mm
CRL9040S13	13 mm	17 mm
CRL9040S18	19 mm	24 mm
CRL9040S23	22 mm	27 mm
CRL9040S28	29 mm	33 mm
CRL9040S33	33 mm	38 mm