



A modern office interior featuring glass partitions and orange walls. The space includes a desk with two computer monitors, a black ergonomic chair, and a white storage unit. The glass partitions are held in place by metal door rails. The floor is made of light-colored concrete tiles. A red ottoman is visible in the bottom right corner.

CRL DOOR RAIL & COMMERCIAL DOOR HARDWARE SYSTEMS

CATDRM_05_25_ZD

CRL DOOR RAIL SYSTEMS & COMMERCIAL DOOR HARDWARE



Page Contents

1	DRM Door Rails
2	DRM80 Door Rail and Lock Kits
3	DRM80 Door Rail Details
4	DRM100 Door Rail and Lock Kits
5	DRM100 Door Rail Details
6	DRM80/100 Sidelite Rails & End Caps
8	DRM Door Rail Accessories
10	Door Patches
12	Hydraulic Bottom Patch Fittings
13	Transom Patch Fittings
14	Transom Patch Fittings & Door Stops
15	Patch Inserts
16	Glass Door Patch Locks
18	CRL Electronic Magnetic Locks & Accessories
20	CRL Overhead Concealed Closers and Headers
21	CRL Floor Mounted Door Closers
22	Free Swinging Pivots
23	CRL Glass Mounted Latches and Lever Handles
25	Wet & Dry Glaze Commercial U-Channel
26	CRL Ladder Style Handles
28	CRL "D" & Square Style Handles



DRM DOOR RAILS

CRL DRM Door Rails are 2-piece extruded aluminium clamping systems that are tightened with cap screws at 100 mm centre to centre. These systems are suitable for the installation of heavy-duty wide doors. There are two heights of 80 mm (DRM80) and 100 mm (DRM100) to choose from and in lengths based on your requirement.

With its clamping efficiency carefully considered, CRL DRM Door rails do not require any glass preparation and can be used with various glass thicknesses such as 10, 12, 15 and 19 mm. In addition, there is a choice of both satin anodised, brushed aluminium and matt black snap-on cover plates.

CRL Door Rails are also available with secure locking devices featuring key cylinders or thumb-turn cylinders.

To complete the aesthetic facade of the glass panels, we offer matching sidelight rail packages.

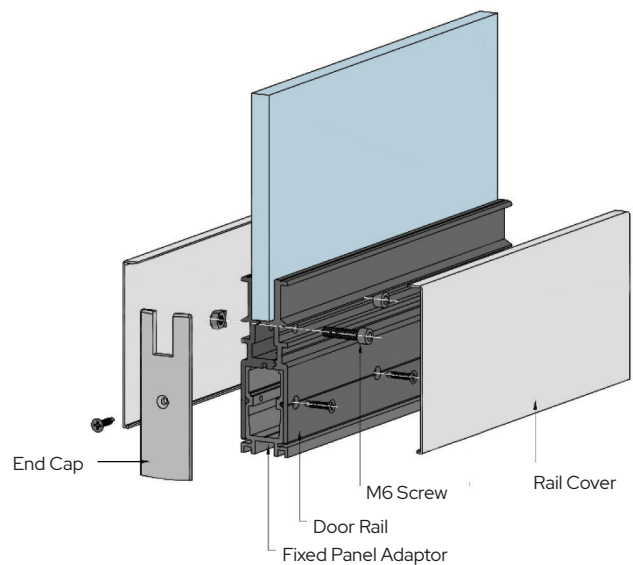

TYPICAL DOOR LAYOUT

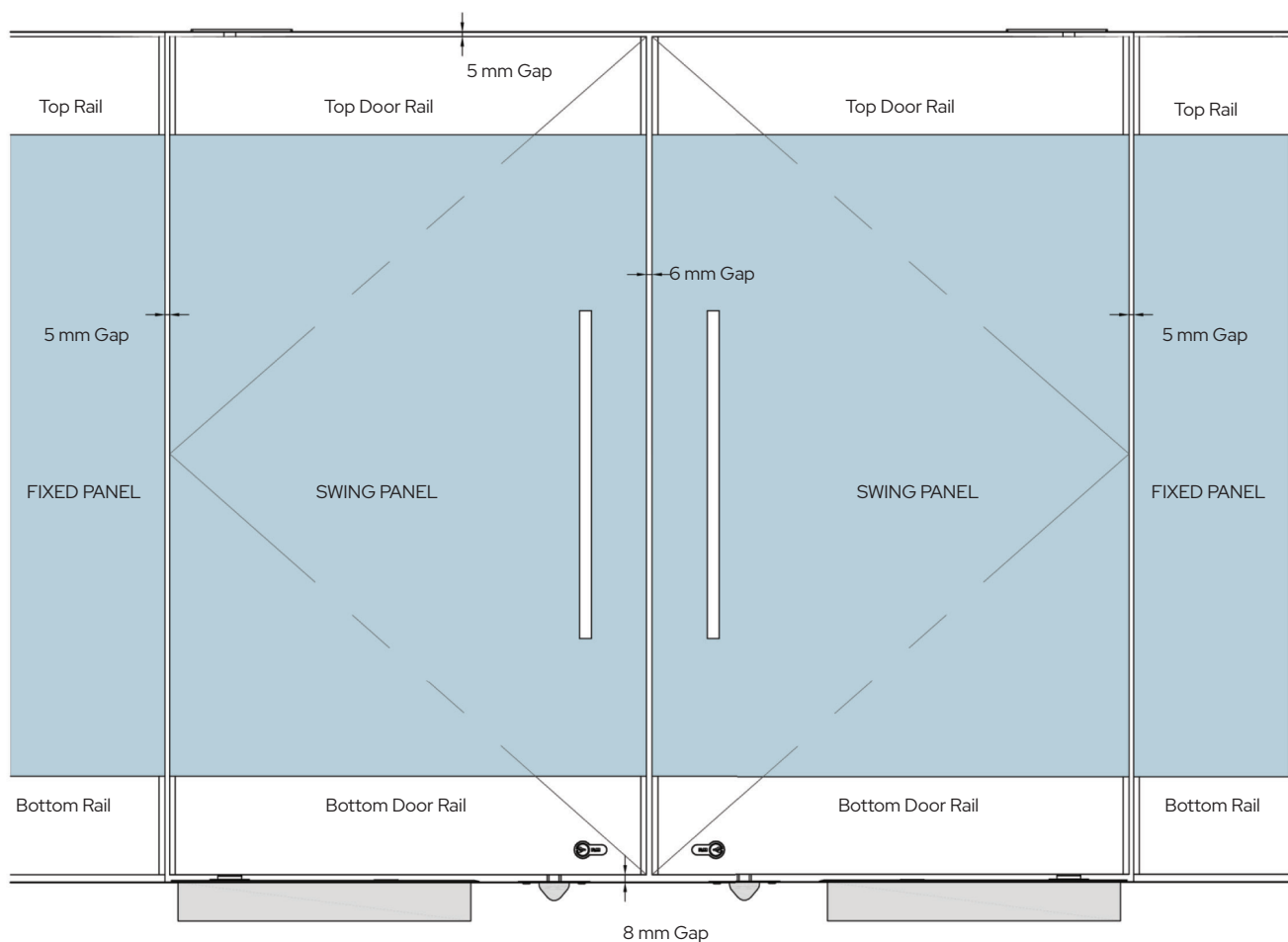

DRM80 DOOR RAILS & LOCK KITS

CRL 80MM CUSTOM LENGTH DOOR RAILS FOR 12MM GLASS

10 mm Glass Option Available with the use of Additional Gaskets Cat. No. DRMG1MM

80MM STANDARD TOP DOOR RAILS 500MM - 1500MM



CAT. NO.	FINISHES
DRM80TSA12	Satin Anodised
DRM80TBS12	Brushed Aluminium
DRM80TML12	Matt Black

80MM OVERHEAD CLOSER TOP DOOR RAILS 500MM - 1500MM

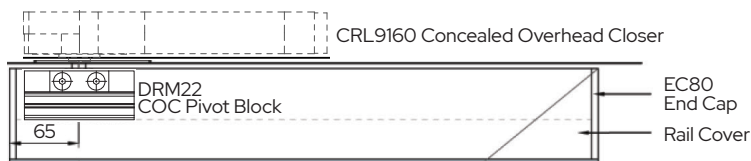

CAT. NO.	FINISHES
DRM80TCSA12	Satin Anodised
DRM80TCBS12	Brushed Aluminium
DRM80TCMBL12	Matt Black

80MM BOTTOM DOOR RAILS 500MM - 1500MM

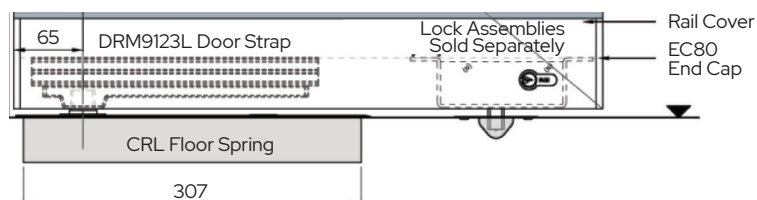

CAT. NO.	FINISHES
DRM80BSA12	Satin Anodised
DRM80BBS12	Brushed Aluminium
DRM80BMBL12	Matt Black

DROP PIN LOCK KIT EURO CYLINDER

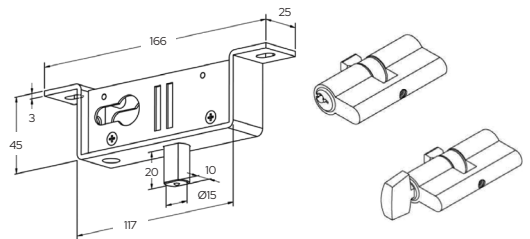

CAT. NO.	DESCRIPTION
DRLEUROKK	Euro Key/Key Assembly
DRLEUROKT	Euro Key/Thumbturn Assembly

* LOCK KITS INCLUDE COST OF INSTALLATION INTO THE DOOR RAILS

SWINGING TONGUE LOCK KIT OVAL CYLINDER

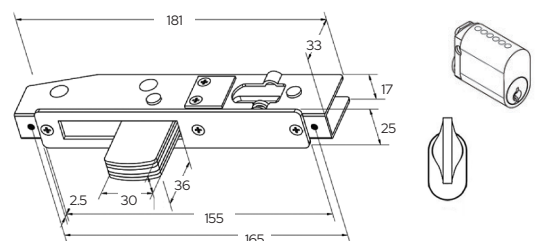

CAT. NO.	DESCRIPTION
DRL590KK	Euro Key/Key Assembly
DRL590KT	Euro Key/Thumbturn Assembly

* LOCK KITS INCLUDE COST OF INSTALLATION INTO THE DOOR RAILS

DRM80 DOOR RAIL DETAIL

DRM80 Door Rails are available with the following standard components:

- DRM80 Rails
- 1NT401 Top Pivot
- DRM2015 Side Load Top Pivot Block
- DRM22 Overhead Closer Top Pivot Block
- DRM9123L Bottom Door Strap
- PL2 Euro Cylinder Lock Bolt
or DRMY590 Oval Cylinder Lock Tongue
- GGH9001WS Keeper for PL2 Lock
or DRMHMT Keeper for 590 Lock

Note: Usage of Door Rails will determine the specific components required, therefore it will differ from the listed standard components.

**CUSTOM DOOR RAIL ONLINE
QUOTE / ORDER FORM**



Specifications to place orders:

- Usage of Door Rails:
Floor Spring
Overhead Concealed Door Closer
Free Pivot Door
- Length of Door Rails:
(Glass Panel Width is Required)
- Door Rails Covers: Snap-On Aluminium Cover
Brushed Aluminium Finish
Satin Anodised Aluminium Finish
- Glass Thickness:
10 mm / 12 mm
- Key Combinations:
Independent - Supplied as standard
Keyed Alike - Available on request
- Lock Type:
Standard Euro Cylinder Bolt Lock
590 Oval Cylinder Tongue Lock

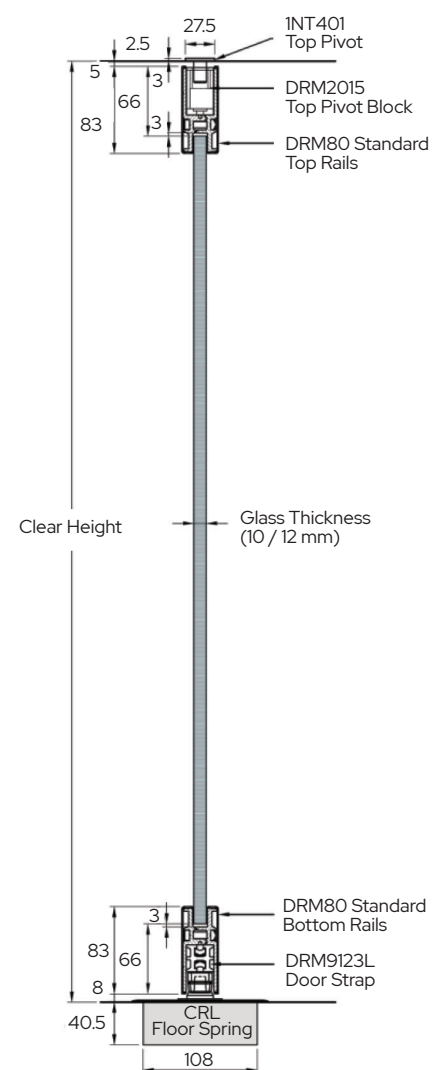
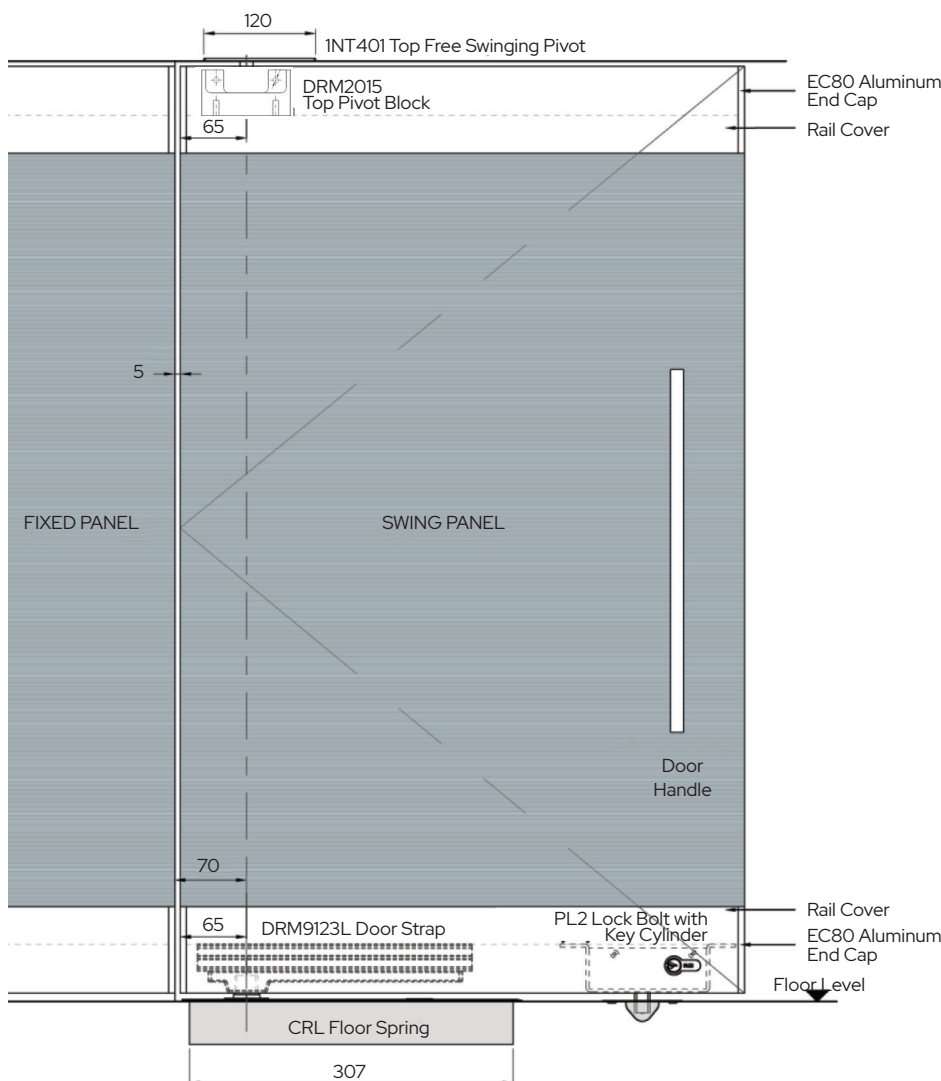

DRM100 DOOR RAILS & LOCK KITS

CRL 100MM CUSTOM LENGTH DOOR RAILS FOR 12MM GLASS

10 mm Glass Option Available with the use of Additional Gaskets Cat. No. DRMG1MM

100MM STANDARD TOP DOOR RAILS 500MM - 1500MM

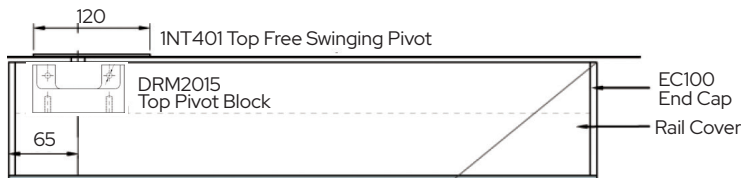

CAT. NO.	FINISHES
DRM100TSA12	Satin Anodised
DRM100TBS12	Brushed Aluminium
DRM100TML12	Matt Black

100MM OVERHEAD CLOSER TOP DOOR RAILS 500MM - 1500MM

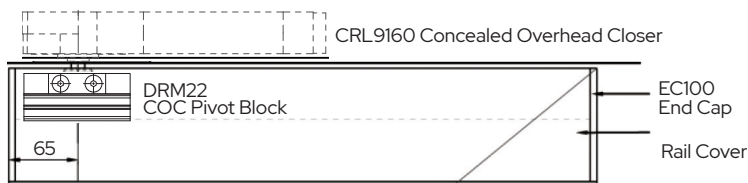

CAT. NO.	FINISHES
DRM100TCSA12	Satin Anodised
DRM100TCBS12	Brushed Aluminium
DRM100TCMBL12	Matt Black

100MM BOTTOM DOOR RAILS 500MM - 1500MM

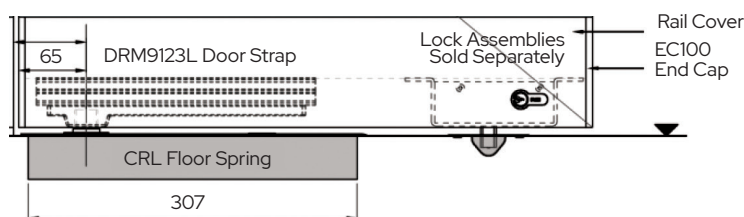

CAT. NO.	FINISHES
DRM100BSA12	Satin Anodised
DRM100BBS12	Brushed Aluminium
DRM100BMBL12	Matt Black

DROP PIN LOCK KIT EURO CYLINDER

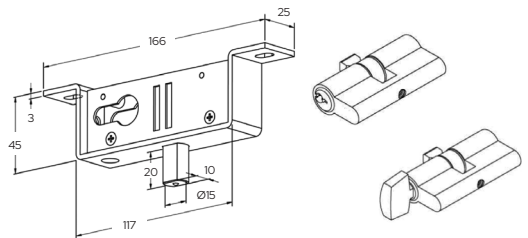

CAT. NO.	DESCRIPTION
DRLEUROKK	Euro Key/Key Assembly
DRLEUROKT	Euro Key/Thumbturn Assembly

* LOCK KITS INCLUDE COST OF INSTALLATION INTO THE DOOR RAILS

SWINGING TONGUE LOCK KIT OVAL CYLINDER

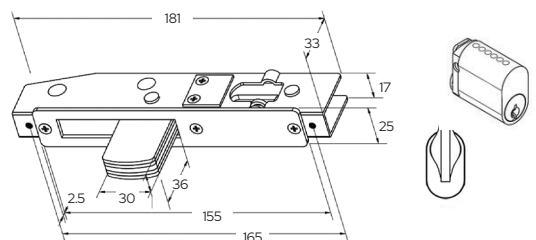

CAT. NO.	DESCRIPTION
DRL590KK	Euro Key/Key Assembly
DRL590KT	Euro Key/Thumbturn Assembly

* LOCK KITS INCLUDE COST OF INSTALLATION INTO THE DOOR RAILS

100MM DOOR RAIL 15MM & 19MM GLASS ADAPTER KITS

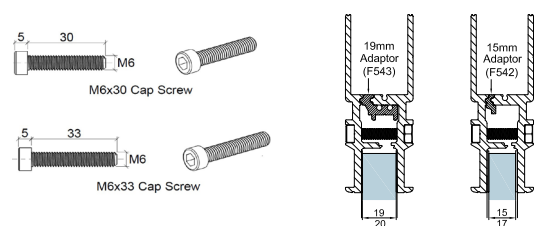

CAT. NO.	FINISHES
DRM10015MMK1T	15mm Glass Adapter Kit
DRM10019MMK1T	19mm Glass Adapter Kit

* ADAPTER KITS INCLUDE COST OF INSTALLATION INTO THE DOOR RAILS
END CAPS SOLD SEPARATELY - PAGE 7

DRM100 DOOR RAIL DETAIL

DRM100 Door Rails are available with the following standard components:

- DRM100 Rails
- 1NT401 Top Pivot
- DRM2015 Side Load Top Pivot Block
- DRM22 Overhead Closer Top Pivot Block
- DRM9123L Bottom Door Strap
- PL2 Euro Cylinder Lock Bolt
or DRMY590 Oval Cylinder Lock Tongue
- GGH9001WS Keeper for PL2 Lock
or DRMHMT Keeper for 590 Lock

NOTE: Usage of Door Rails will determine the specific components required, therefore it will differ from the listed standard components.

CUSTOM DOOR RAIL ONLINE QUOTE / ORDER FORM



Specifications to place orders:

- Usage of Door Rails:
Floor Spring
Overhead Concealed Door Closer
Free Pivot Door
- Length of Door Rails:
(Glass Panel Width is Required)
- Door Rails Covers: Snap-On Aluminium Cover
Brushed Aluminium Finish
Satin Anodised Aluminium Finish
- Glass Thickness:
10 mm / 12 mm / 15 mm / 19 mm
- Key Combinations:
Independent - Supplied as standard
Keyed Alike - Available on request
- Lock Type:
Standard Euro Cylinder Bolt Lock
590 Oval Cylinder Tongue Lock

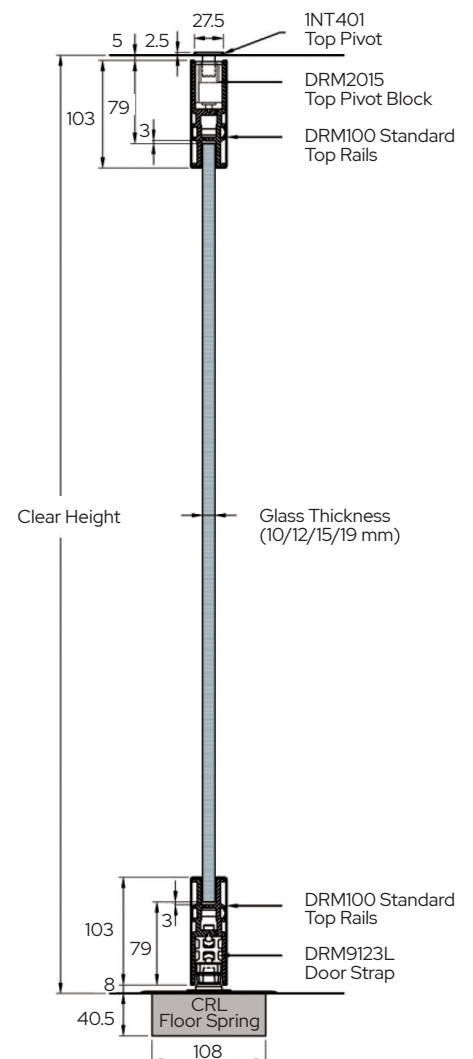
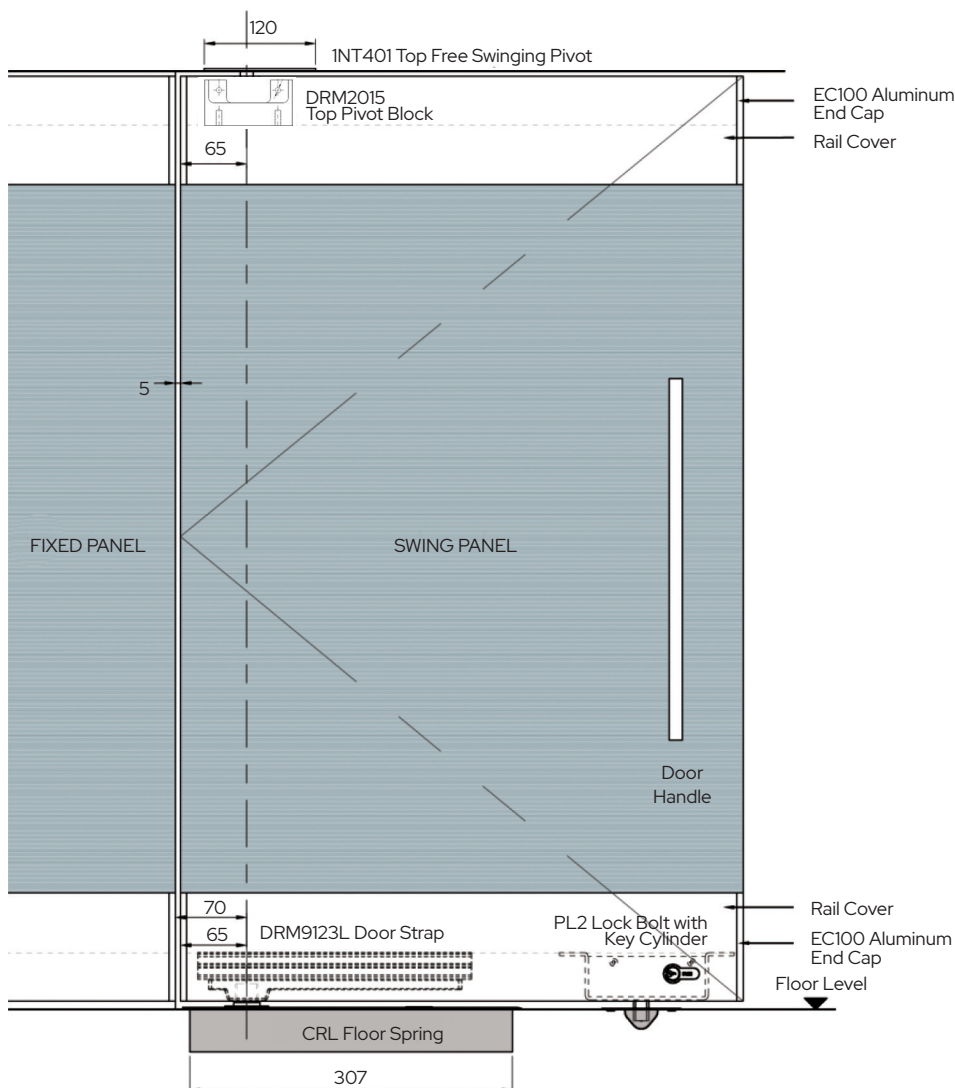

DRM80 & DRM100 SIDELITE RAILS & END CAPS

Rail for Fixed Panel is Designed To:

- Facilitate ease of installation of fixed glass panel
- Eliminate embedding work for fixed glass panel
- Complement the aesthetic facade of fixed glass panel

80mm Fixed Sidelight Rails 2900mm Long

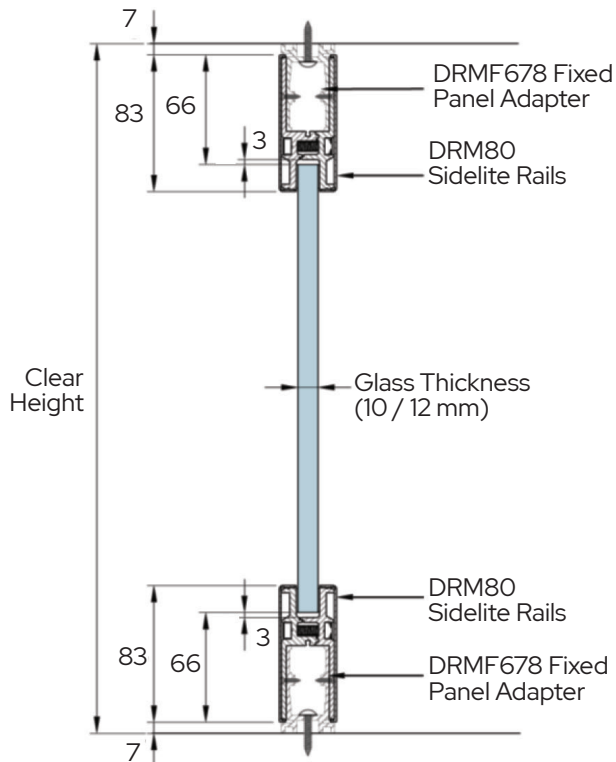

100mm Fixed Sidelight Rails 2900mm Long

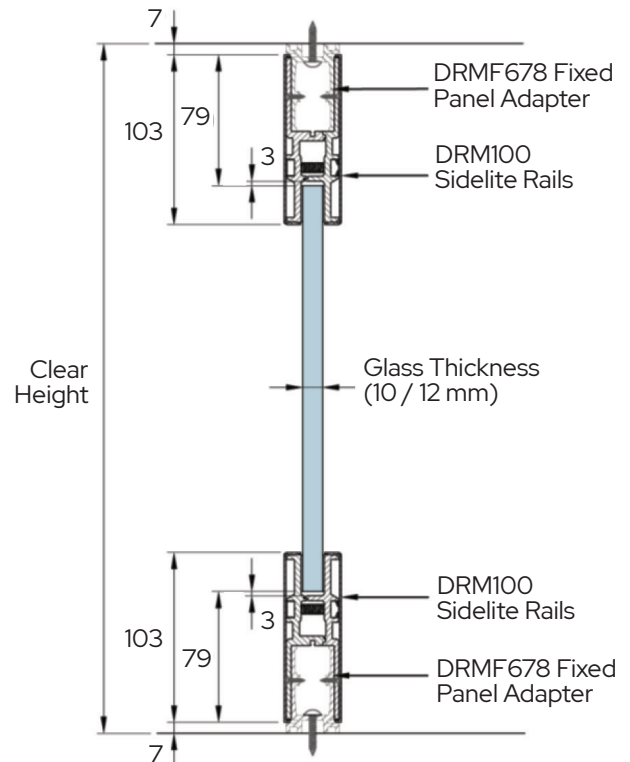

CAT. NO.	FINISHES
DRM80FKSA12	Satin Anodised
DRM80FKBS12	Brushed Aluminium
DRM80FKMBL12	Matt Black

CAT. NO.	FINISHES
DRM100FKSA12	Satin Anodised
DRM100FKBS12	Brushed Aluminium
DRM100FKMBL12	Matt Black

End Caps

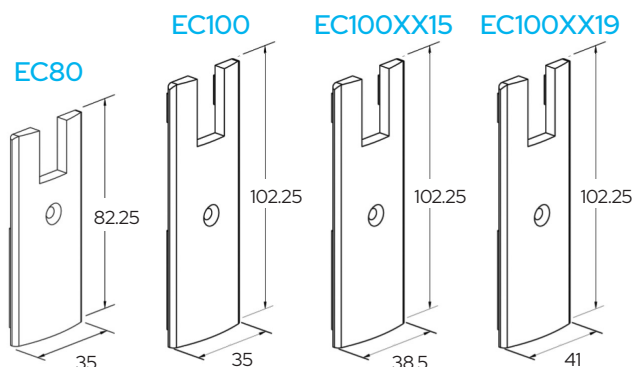

CAT. NO.	FINISHES
EC80SNA	80mm Satin Anodised
EC80B	80mm Brushed Aluminium
EC80MBL	80mm Matt Black
EC100SNA	100mm Satin Anodised
EC100B	100mm Brushed Aluminium
EC100MBL	100mm Matt Black
EC100NA15LH	LH Satin Anodised 15mm Glass
EC100NA15RH	RH Satin Anodised 15 mm Glass
EC100B15LH	LH Brushed Aluminium 15 mm Glass
EC100B15RH	RH Brushed Aluminium 15 mm Glass
EC100MBL15LH	LH Matt Black 15 mm Glass
EC100MBL15RH	RH Matt Black 15 mm Glass
EC100NA19	Satin Anodised 19 mm Glass
EC100B19	Brushed Aluminium 19 mm Glass
EC100MBL19	Matt Black 19 mm Glass



DRM DOOR RAIL ACCESSORIES

LOCK ACCESSORIES

PL2 Lock Bolt

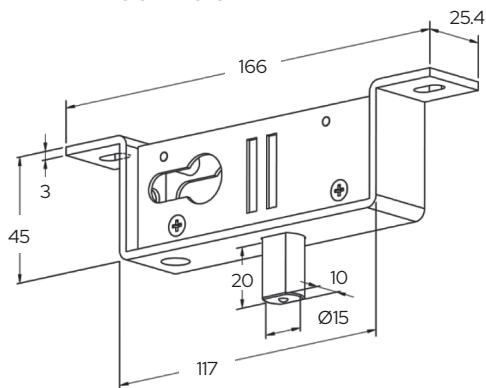

GGHPM88 Euro-Profile Key Cylinder Available Length : 60 mm

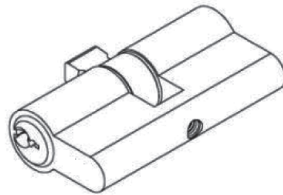

GGHPM88T Euro-Profile Thumb Turn & Key Cylinder Available Length : 60 mm (28 mm thumb turn only)

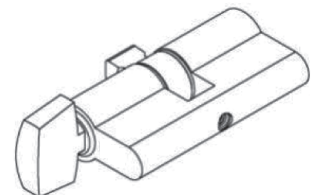

GGH9001WS Drop Bolt Keeper with Cover

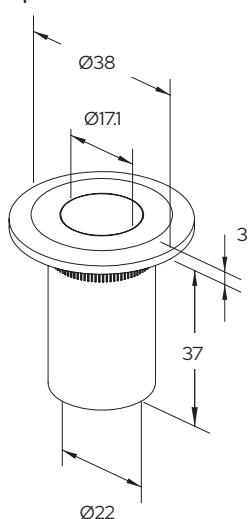

DRMY590CCSC Lock (key-key)
DRMY590CTSC Lock (key-thumb turn)

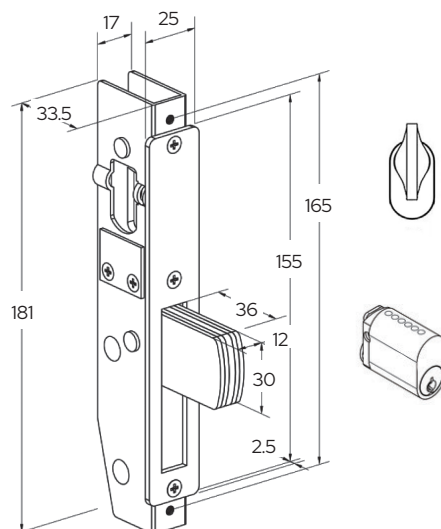

DRMHMT 590 Keeper Plate

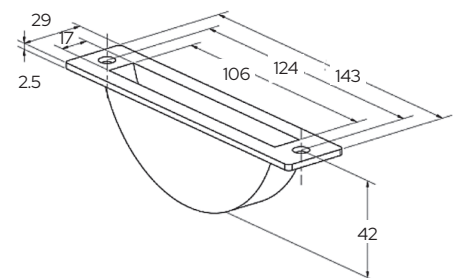

DRMM6X27
DRM Hex Screw with Square Nut for 10 - 12 mm Glass

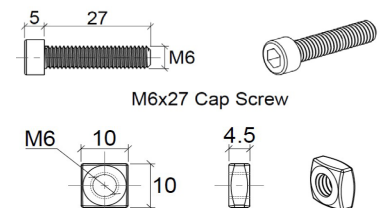

DRMM6X30
DRM Hex Screw with Square Nut for 15 mm Glass

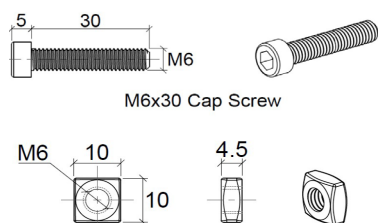

DRMM6X33
DRM Hex Screw with Square Nut for 19 mm Glass

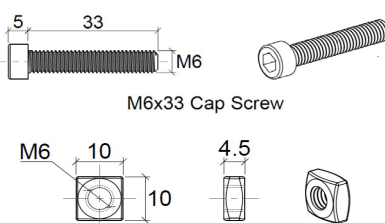

SSCAPS0616
Socket Head Screw for Rail Fittings M6 x 16 mm

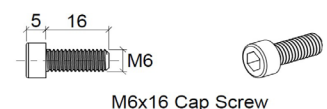

SSHNM06
M6 Hexagon Stainless Steel Nut

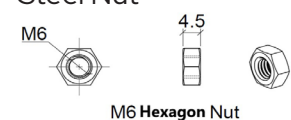

DRM DOOR RAIL ACCESSORIES

TOP RAIL ACCESSORIES

1NT401 Top Free Swinging Pivot

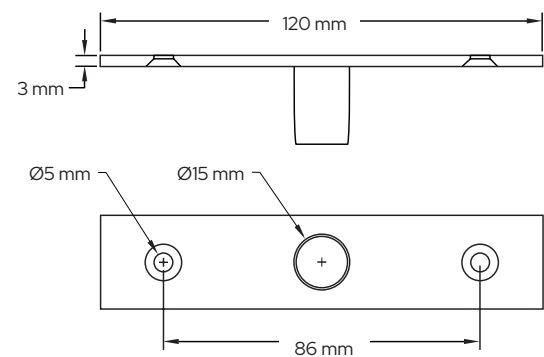

DRM22 Concealed OHC Block

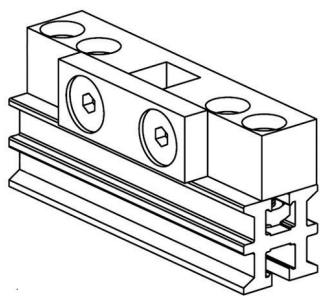

DRM2015 Side Load Top Pivot Block

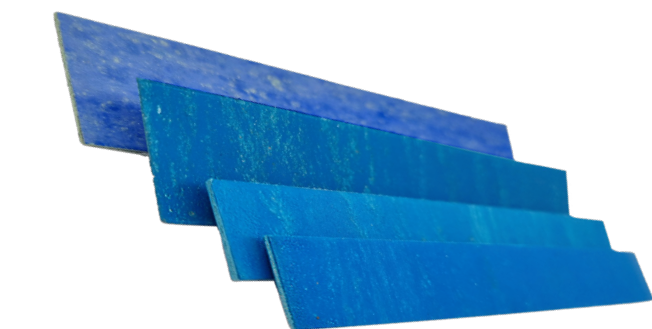
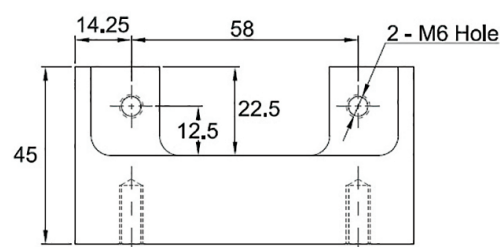

BOTTOM RAIL ACCESSORIES

1NT402 Floor Mounted Bottom Free-Swinging Pivot

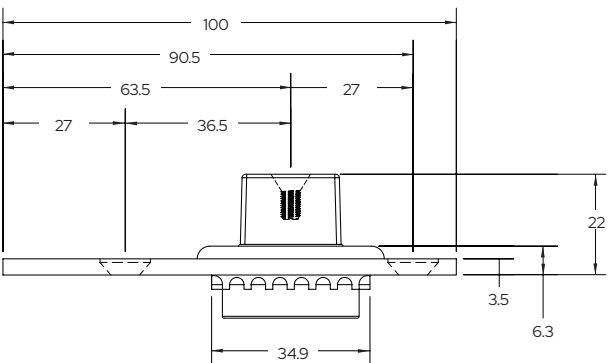

1NT402S5 5 mm Shim for Floor Mounted Bottom Free-Swinging Pivot

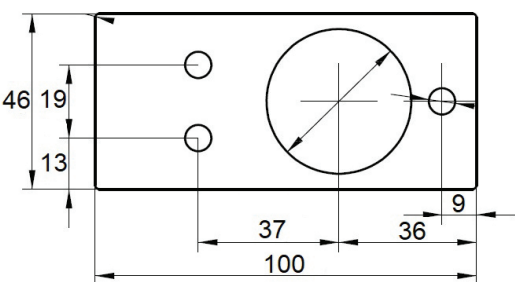

DRM9123L Door Strap

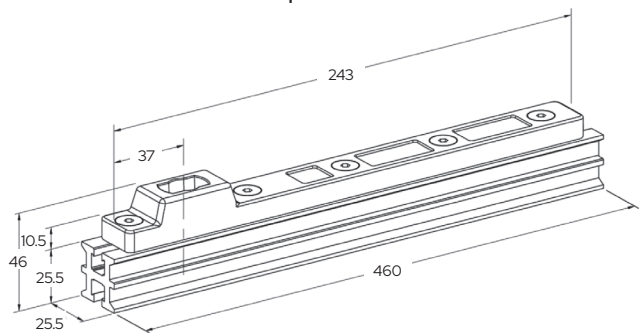

Door Rail Gaskets - 1500mm Long

CAT. NO.	FINISHES
DRMG1MM	80mm Rail Gasket 1 mm Thick
DRMG1MM100	100mm Rail Gasket 1 mm Thick
DRMG2MM	80mm Rail Gasket 2 mm Thick
DRMG2MM100	100mm Rail Gasket 2 mm Thick

DOOR PATCHES

CRL European Top Door Patch Fitting

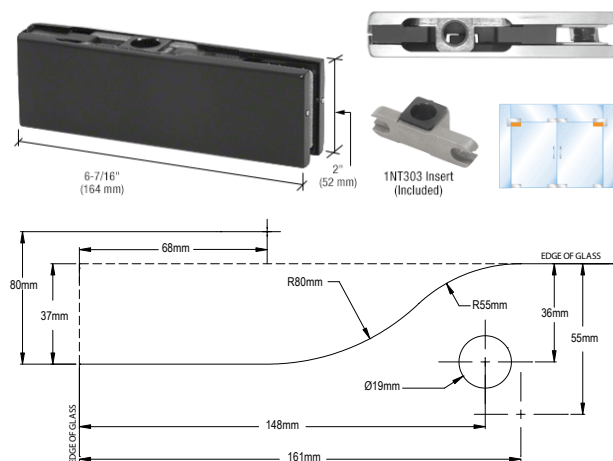

- Suited for 10 & 12 mm Thick Glass
- 65 mm Pivot Offset
- Available in Six Finishes

CAT. NO.	FINISHES
PH21ABS	Brushed Stainless
PH21APS	Polished Stainless
PH21AMBL	Matt Black
PH21AA	Satin Anodised
PH21ABR	Polished Brass

CRL European Bottom Door Patch Fitting

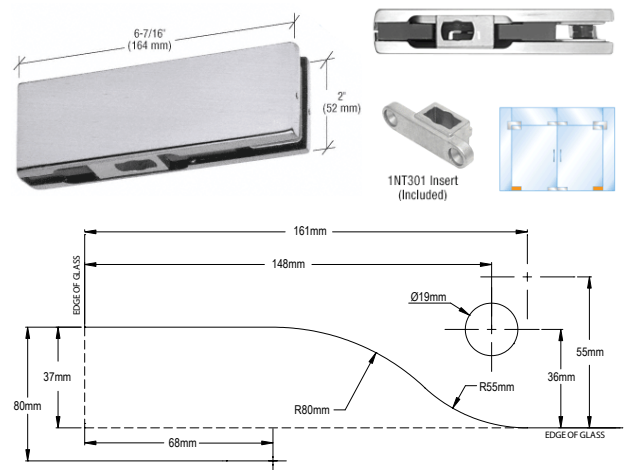

- Suited for 10 & 12 mm Thick Glass
- 65 mm Pivot Offset
- Available in Six Finishes

CAT. NO.	FINISHES
PH11CBS	Brushed Stainless
PH11CPS	Polished Stainless
PH11CMBL	Matt Black
PH11CA	Satin Anodised
PH11CBR	Polished Brass

CRL North American Top Door Patching Fitting

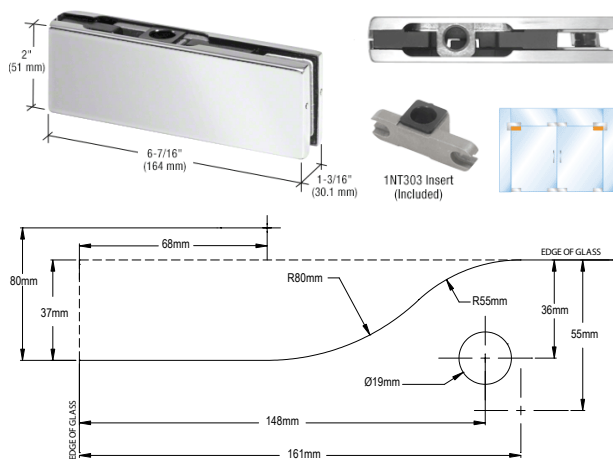

- Suited for 10 & 12 mm Thick Glass
- 70 mm Pivot Offset
- Available in Six Finishes

CAT. NO.	FINISHES
PH20ABS	Brushed Stainless
PH20APS	Polished Stainless
PH20AMBL	Matt Black
PH20AA	Satin Anodised
PH20ABR	Polished Brass

CRL North American Bottom Door Patching Fitting

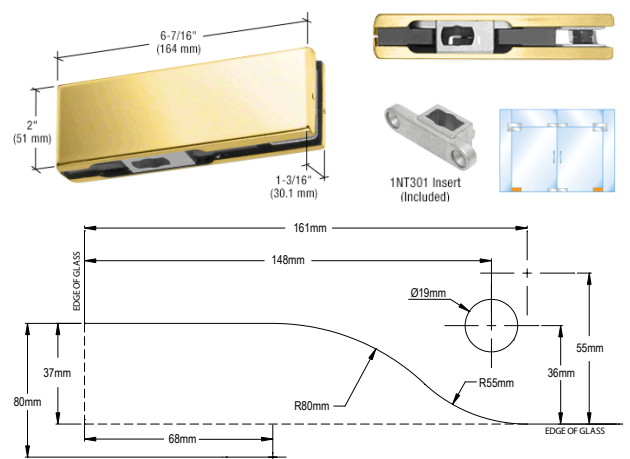

- Suited for 10 & 12 mm Thick Glass
- 70 mm Pivot Offset
- Available in Six Finishes

CAT. NO.	FINISHES
PH10CBS	Brushed Stainless
PH10CPS	Polished Stainless
PH10CMBL	Matt Black
PH10CA	Satin Anodised
PH10CBR	Polished Brass

DOOR PATCHES

CRL European Top Door COC Patch Fitting

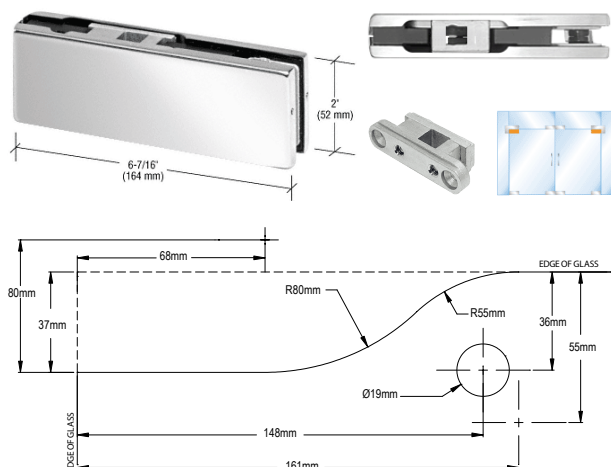

- Suited for 10 & 12 mm Thick Glass
- 65 mm Pivot Offset
- Available in Four Finishes

CAT. NO.	FINISHES
PH21BBS	Brushed Stainless
PH21BPS	Polished Stainless
PH21BMBL	Matt Black
PH21BA	Satin Anodised
PH21BBR	Polished Brass

CRL North American Top Door COC Patch Fitting

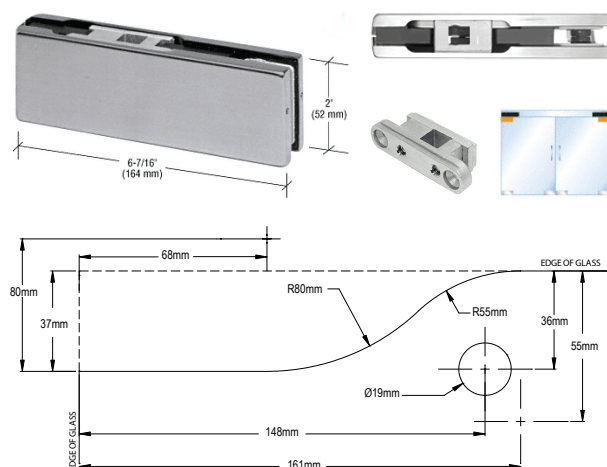

- Suited for 10 & 12 mm Thick Glass
- 70 mm Pivot Offset
- Available in Four Finishes

CAT. NO.	FINISHES
PH20BBS	Brushed Stainless
PH20CPS	Polished Stainless
PH20BMBL	Matt Black
PH20CA	Satin Anodised
PH20CBR	Polished Brass

CRL North American & European Top or Bottom Patch Only



- AMR201 Series
- EUR201 Series
- Available in Several Finishes

AMR CAT. NO.	EUR CAT. NO.	FINISHES
AMR201BS	EUR201BS	Brushed Stainless
AMR201PS	EUR201PS	Polished Stainless
AMR201MBL	EUR201MBL	Matt Black
AMR201A	EUR201A	Satin Anodised
AMR201BR	EUR201BR	Polished Brass

CRL Replacement Gaskets and Grommets for PH10, PH11, PH20, PH21 and PH34 Patch Fittings

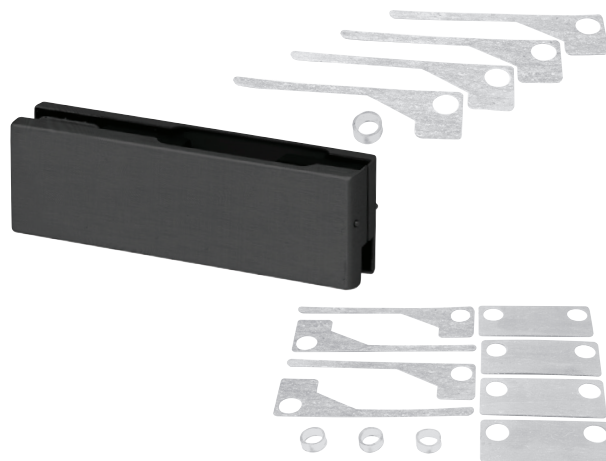

- Covers Available in Six Finishes

CAT. NO.	FINISHES
1NT101BS	Brushed Stainless
1NT101PS	Polished Stainless
1NT101MBL	Matt Black
1NT101A	Satin Anodised
1NT101SB	Satin Brass
1NT101BR	Polished Brass
GS101	Standard Patch Gasket Kit
GS103	PH40 Patch Gasket Kit

HYDRAULIC BOTTOM PATCH FITTING

CRL Hydraulic Bottom Patch Fitting



- Suited for 10 & 12 mm Thick Glass
- 65 mm Pivot Offset
- 100 kg Weight Limit
- Maximum Door Width 1000 mm
- Used with PH21 Top Patches
- 90° Hold Open & Non Hold Open Options Available

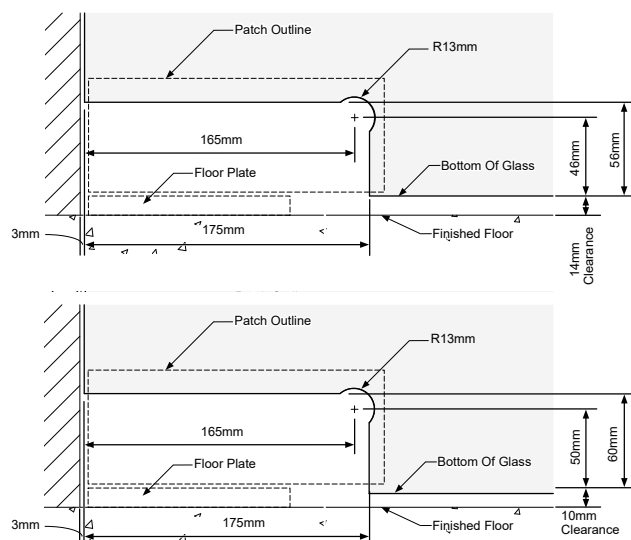

CAT. NO.	DESCRIPTION	FINISHES
CRL380BS	CRL Hydraulic Patch Fitting - No Hold Open	Brushed Stainless
CRL380PS	CRL Hydraulic Patch Fitting - No Hold Open	Polished Stainless
CRL380MBL	CRL Hydraulic Patch Fitting - No Hold Open	Matt Black
CRL380A	CRL Hydraulic Patch Fitting - No Hold Open	Satin Anodised
CRL380HBS	CRL Hydraulic Patch Fitting - 90° Hold Open	Brushed Stainless
CRL380HPS	CRL Hydraulic Patch Fitting - 90° Hold Open	Polished Stainless
CRL380HMBL	CRL Hydraulic Patch Fitting - 90° Hold Open	Matt Black
CRL380HA	CRL Hydraulic Patch Fitting - 90° Hold Open	Satin Anodised

CRL Hydraulic Patch Fitting Door Set



- Suited for 10 & 12 mm Thick Glass
- 65 mm Pivot Offset
- Includes Bottom Hydraulic Patch, PH21A Top Patch and Top Free Swinging Pivot
- 100 kg Weight Limit
- 90° Hold Open
- Available in Three Finishes

CAT. NO.	FINISHES
CRL380HBSSET	Brushed Stainless
CRL380HPSSET	Polished Stainless
CRL380HMBLSET	Matt Black

CRL Hydraulic Patch Fitting Replacement Covers



- Replacement for CRL380/H Hydraulic Patch Closer
- Available in Four Finishes

CAT. NO.	FINISHES
CRL380COVERBS	Brushed Stainless
CRL380COVERPS	Polished Stainless
CRL380COVERMBL	Matt Black
CRL380COVERA	Satin Anodised

TRANSOM PATCH FITTINGS

CRL Sidelite Transom Patch Fitting

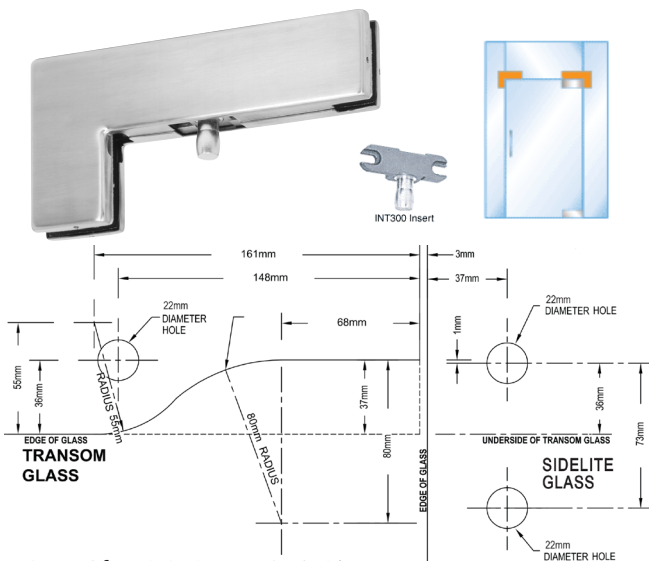

- Suited for 10 & 12 mm Thick Glass
- 65 mm Pivot Offset
- Available in Five Finishes

CAT. NO.	FINISHES
PH40BS	Brushed Stainless
PH40PS	Polished Stainless
PH40MBL	Matt Black
PH40A	Satin Anodised
PH40BR	Polished Brass

CRL Replacement Cover Plates for PH40 Patch Fitting



- For PH40 Sidelite Mounted Transom Patch Fittings
- Available in Six Finishes

CAT. NO.	FINISHES
1NT103BS	Brushed Stainless
1NT103PS	Polished Stainless
1NT103A	Satin Anodised
1NT103BR	Polished Brass
1NT103SB	Satin Brass
1NT103DU	Black / Bronze

CRL Wall Mounted Transom Patch Fitting

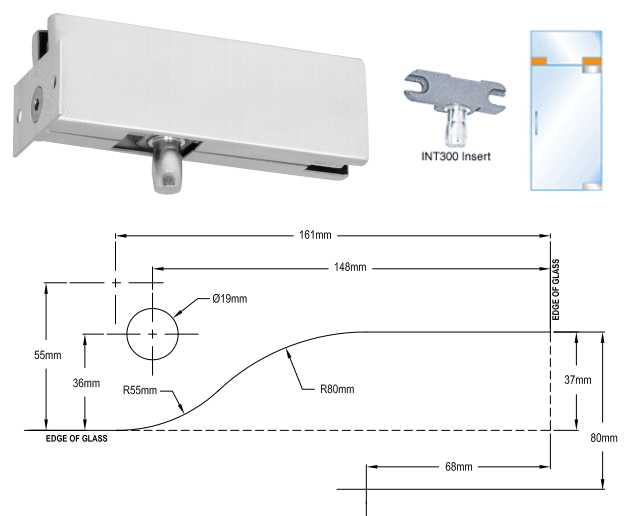

- Suited for 10 & 12 mm Thick Glass
- 65 mm Pivot Offset
- Available in Six Finishes

CAT. NO.	FINISHES
PH34BS	Brushed Stainless
PH34PS	Polished Stainless
PH34MBL	Matt Black
PH34A	Satin Anodised
PH34BR	Polished Brass



TRANSOM PATCH FITTINGS & DOOR STOPS

CRL Sidelite Mounted Transom Patch with Reversible Door Stop

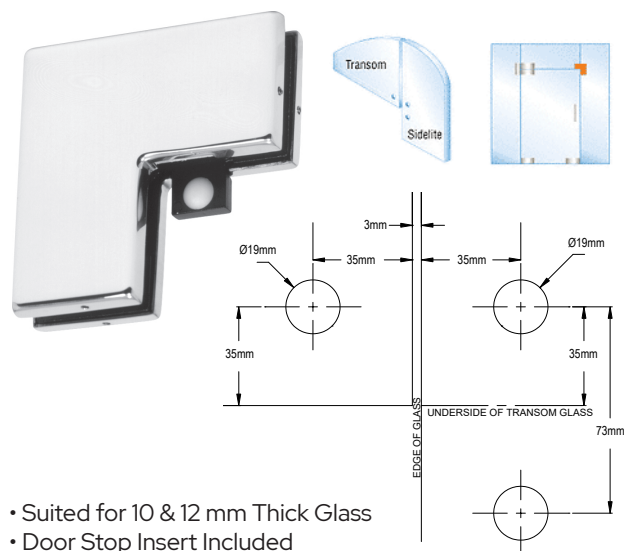

- Suited for 10 & 12 mm Thick Glass
- Door Stop Insert Included
- Available in Five Finishes

CAT. NO.	FINISHES
PH60BS	Brushed Stainless
PH60PS	Polished Stainless
PH60A	Satin Anodised
PH60DU	Black / Bronze
PH60BR	Polished Brass

CRL Transom Mounted Connector with Two Reversible Doorstops

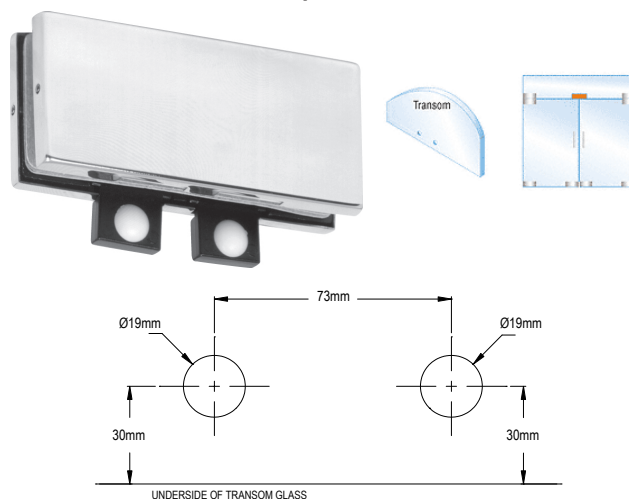

- Suited for 10 & 12 mm Thick Glass
- Door Stops Insert Included
- Available in Five Finishes

CAT. NO.	FINISHES
PH70BS	Brushed Stainless
PH70PS	Polished Stainless
PH70A	Satin Anodised
PH70MBL	Matt Black
PH70BR	Polished Brass

CRL Transom Patch Door Stop Insert

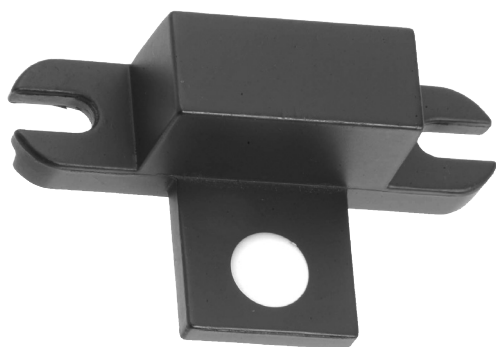

- Suitable for a Variety of Patches; PH34, PH40, PH41L, PH41R, PH42L, PH42R, PH43L, PH43R and PH51 Transom Patch Fittings to Create a Door Stop

CAT. NO.	DESCRIPTION
1NT306	Transom Patch Door Stop Insert

CRL Single & Double Header Mounted Doorstop

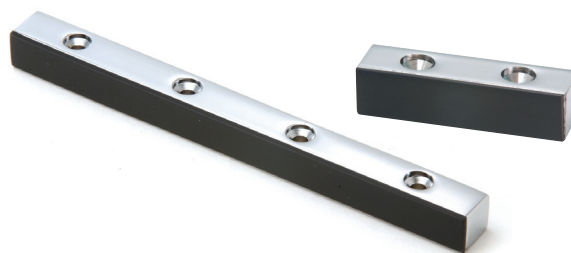

- Available Lengths; Single 51 mm, Double 102 mm
- 12 x 12 mm Slimline Profile
- Available in Six Finishes

CAT. NO.	TYPE	FINISHES
1NT307BS	Single	Brushed Stainless
1NT307PS	Single	Polished Stainless
1NT307A	Single	Satin Anodised
1NT307BR	Single	Polished Brass
1NT307DU	Single	Black / Bronze
1NT307MBL	Single	Matt Black
1NT308BS	Double	Brushed Stainless
1NT308PS	Double	Polished Stainless
1NT308A	Double	Satin Anodised
1NT308BR	Double	Polished Brass
1NT308DU	Double	Black / Bronze
1NT308MBL	Double	Matt Black

PATCH INSERTS

CRL Bottom Door Patch Insert To Fit Tapered Spindle

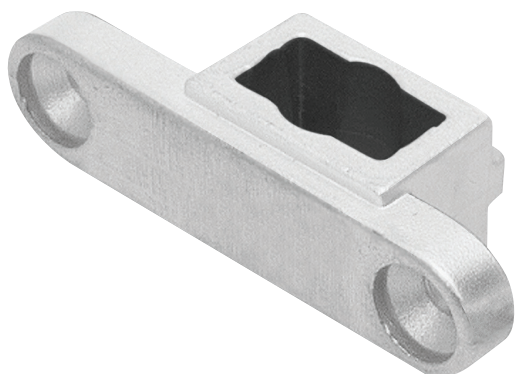

- For Use With PH10 and PH11 Bottom Door Patches
- Universal Tapered Spindle Design
- Fits All Floor Closers & Free Swinging Bottom Pivots

CAT. NO.	DESCRIPTION
1NT301	Bottom Door Patch Insert to Fit Tapered Spindle

CRL Adjustable Top Door Patch Insert

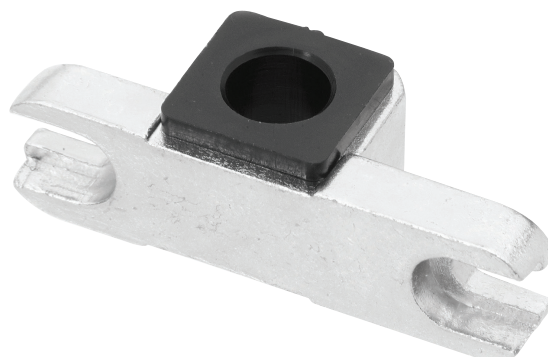

- For Use With PH20 and PH21 Top Door Patches
- Universal Spindle for 15 mm Pivot
- Fits All Free Swinging Overhead Pivots

CAT. NO.	DESCRIPTION
1NT303	Adjustable Top Door Patch Insert

CRL Top Door Closer Patch Insert

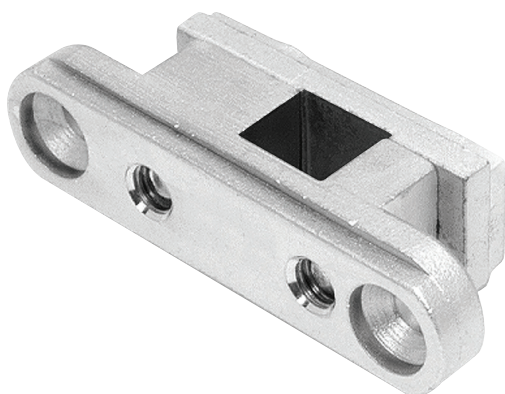

- For Use With PH20 and PH21 Top Door Patches
- Suitable for use with Standard 14 mm Square Spindle Overhead Concealed Door Closers

CAT. NO.	DESCRIPTION
1NT304	Top Door Closer Patch Insert

CRL Transom Patch Top Pivot Insert



- For Use With: PH34, PH40, PH41L, PH41R, PH42L, PH42R, PH43L, PH43R and PH51 Transom Patch Fittings
- Adjustment available for 65 mm & 70 mm pivot offset

CAT. NO.	DESCRIPTION
1NT300	Transom Patch Top Pivot Insert

GLASS DOOR PATCH LOCKS

CRL European Series Patch Door Lock

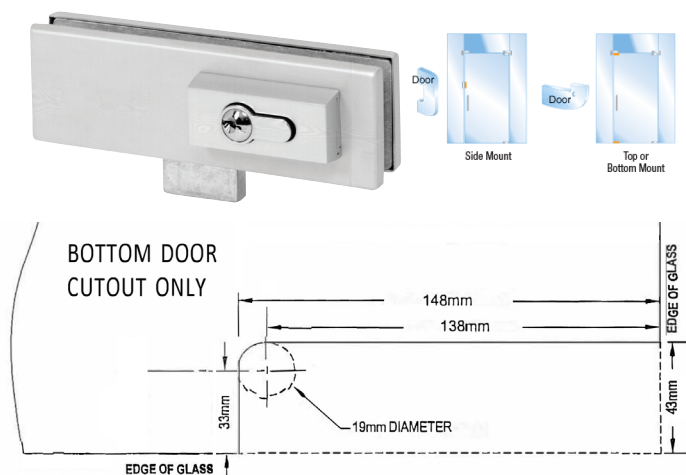

- Suited for 10 & 12 mm Thick Glass
- Supplied with Key / Key Cylinder
- Available in Seven Finishes

CAT. NO.	FINISHES
EUR205BS	Brushed Stainless
EUR205PS	Polished Stainless
EUR205MBL	Matt Black
EUR205A	Satin Anodised
EUR205SB	Satin Brass
EUR205BR	Polished Brass
EUR205DU	Black Bronze

CRL European Series Patch Door Lock Receiver



- Suited for 10 & 12 mm Thick Glass
- Accepts EUR205 Lock Throw
- Available in Seven Finishes

CAT. NO.	FINISHES
EUR206BS	Brushed Stainless
EUR206PS	Polished Stainless
EUR206MBL	Matt Black
EUR206A	Satin Anodised
EUR206SB	Satin Brass
EUR206BR	Polished Brass
EUR206DU	Black Bronze

CRL EUR Series Center Housed Patch Door Lock

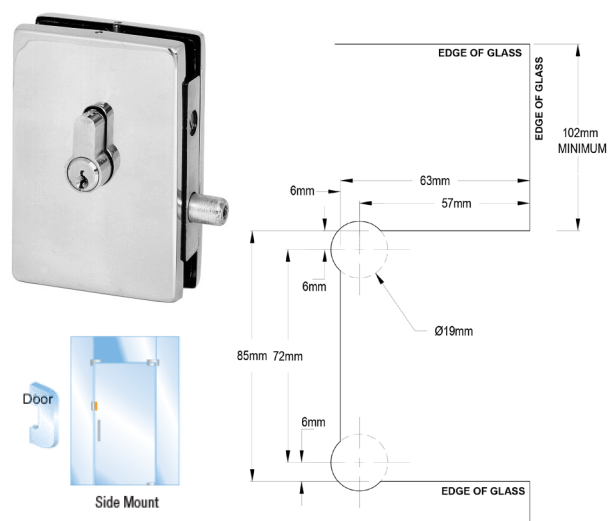

- Suited for 10 & 12 mm Thick Glass
- Key / Key Cylinder Included
- Available in Four Finishes

CAT. NO.	FINISHES
EUR681BS	Brushed Stainless
EUR681PS	Polished Stainless
EUR681A	Satin Anodised
EUR681BR	Polished Brass

CRL EUR Series Center Housed Patch Door Lock Receiver

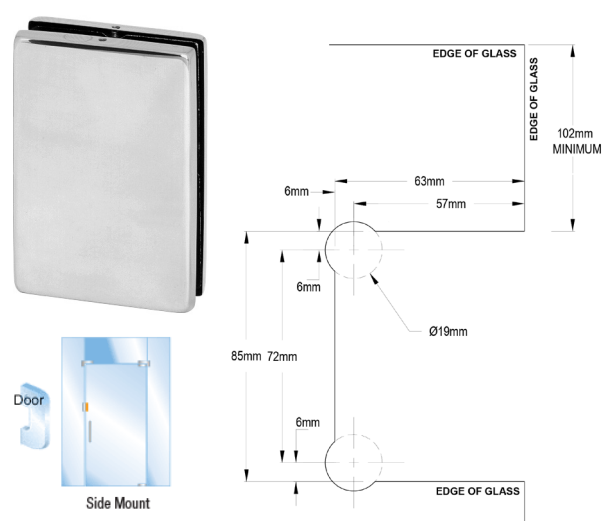

- Suited for 10 & 12 mm Thick Glass
- Key / Key Cylinder Included
- Available in Four Finishes

CAT. NO.	FINISHES
EUR682BS	Brushed Stainless
EUR682PS	Polished Stainless
EUR682A	Satin Anodised
EUR682BR	Polished Brass

GLASS DOOR PATCH LOCKS

CRL EUR Series Bottom Patch Door Lock

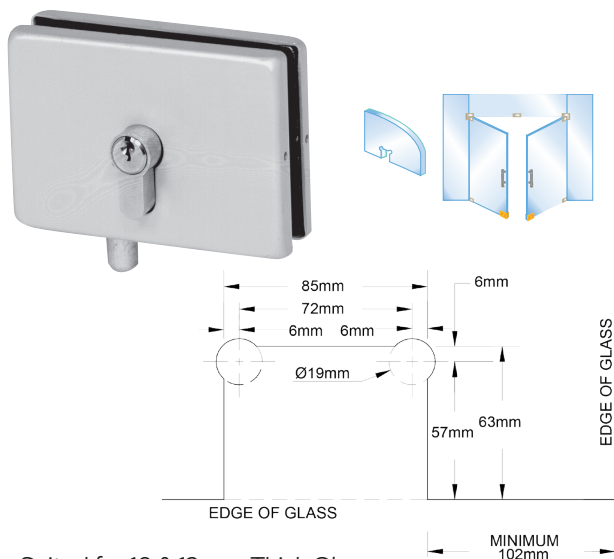

- Suited for 10 & 12 mm Thick Glass
- Key / Key Cylinder Included
- Available in Four Finishes

CAT. NO.	FINISHES
EUR680BS	Brushed Stainless
EUR680PS	Polished Stainless
EUR680A	Satin Anodised
EUR680BR	Polished Brass

CRL Chrome Deluxe Slip-On Showcase Lock

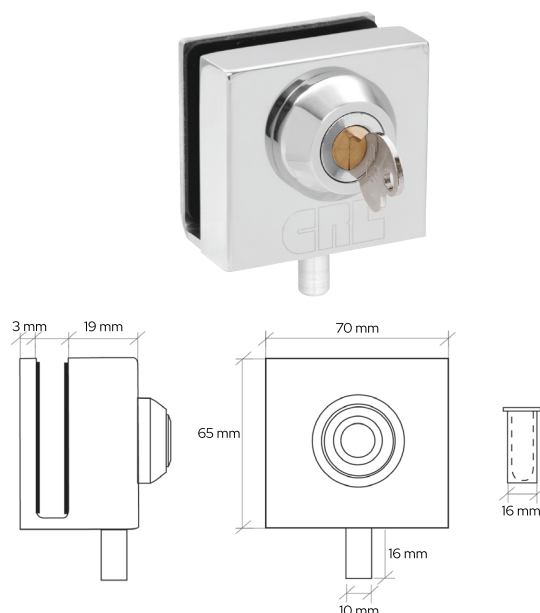

- Suited for 10 & 12 mm Thick Glass
- Supplied with Three Keys & Drop Bolt Keeper
- Polished Stainless Steel Finish

CAT. NO.	GLASS THICKNESS
03P38	10 mm
03P12	12 mm

CRL Dust Proof Pin Lock Keeper



- Suited for 16mm Lock Pin Diameters
- 25 mm Wide x 51 mm Deep Hole Required for Install
- Spring Loaded Mechanism Keeps Debris Out

CAT. NO.	FINISHES
AMR207BN	Brushed Nickel
AMR207PS	Polished Stainless
AMR207BR	Polished Brass

CRL Polished Stainless Finish "Easy Clean" European Style Bottom Keeper With Mounting Plate



- Suited for EUR205 Series Patch Lock
- Easy Clean Design to Prevent Debris Build Up
- Polished Stainless Steel Finish

CAT. NO.	FINISH
EUR208PS	Polished Stainless

CRL ELECTRONIC MAGNETIC LOCKS & ACCESSORIES

CRL Standard Electromagnetic Single Door Lock



- Holding Force 544 kg
- For Interior Use
- Dual Voltage 12/24 Volts DC
- Length - 265mm, Height - 75mm, Depth - 41mm
- Aluminum Housing with Brushed Aluminum Finish
- Standard Wiring Unmonitored

CAT. NO.	DESCRIPTION
MLST1200U	Standard Single Mag Lock

CRL Standard Electromagnetic Double Door Lock



- Holding Force 544 kg
- For Interior Use
- Dual Voltage 12/24 Volts DC
- Length - 534mm, Height - 75mm, Depth - 41mm
- Aluminum Housing with Brushed Aluminum Finish
- Standard Wiring Unmonitored

CAT. NO.	DESCRIPTION
MLST1202U	Standard Double Mag Lock

CRL Weatherproof Electromagnetic Lock



- Sealed in a Stainless Steel Housing to Resist Severe Weather Conditions
- For Interior or Exterior Use
- Dual Voltage 12/24 Volts DC
- Length - 203mm, Height - 44mm, Depth - 48mm
- Aluminum Housing with Brushed Aluminum Finish
- Standard Wiring Unmonitored

CAT. NO.	DESCRIPTION
ML1200U	Weatherproof Single Mag Lock

SDC® Herculite™ + Slip-On Glass Door Bracket for Electromagnetic Locks

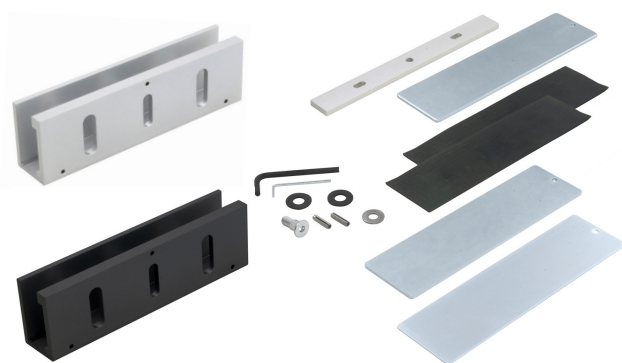

- Sealed in a Stainless Steel Housing to Resist Severe Weather Conditions
- Length - 265mm, Height - 75mm, Depth - 41mm
- Aluminum Housing with Brushed Aluminum Finish
- Standard Wiring Unmonitored

CAT. NO.	FINISH
HDB1	Satin Anodised
HDB1MBL	Matt Black

CRL ELECTRONIC MAGNETIC LOCKS & ACCESSORIES

CRL Brushed Stainless Programmable Digital Keypad



- Designed for Access Control and Security Applications With 100 User Codes
- Four Programmable Code Levels: Master/User/Duress/Quick
- 12/24 Volts AC/DC Voltage

CAT. NO.	DESCRIPTION
MLDK83N	Programmable Digital Keypad

CRL Illuminated Exit Button



- Narrow Style Illuminated SPDT for Use With Electric Strikes and Magnetic Locks

CAT. NO.	DESCRIPTION
MLEB4NS	Illuminated Exit Button



Blumcraft® Custom Panic Handles

OVERHEAD CONCEALED DOOR CLOSERS & HEADERS

- Extended 19 mm Long Spindle Available for Use with Patch Fittings and Door Rail Hardware
- Available in Light, Medium, Heavy and Adjustable Spring Models.
- Conveniently Packaged With Templates and Instructions

- 5 Year Limited Warranty
- Max Weight Limit of 91 kg



Extended Spindle
19 mm Length
for use with Patch Fittings
and Door Rail Hardware or
when extra reach is needed.

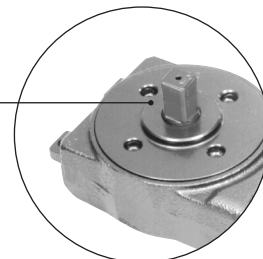

Standard Spindle Models

CODE	DESCRIPTION
CRL7160	90 Degree Medium Hold Open
CRL7162	90 Degree Medium No Hold Open
CRL6760	90 Degree Adjustable Spring Hold Open
CRL6762	90 Degree Adjustable Spring No Hold Open

Extended Spindle Models

CODE	DESCRIPTION
CRL9160	90 Degree Medium Hold Open
CRL9162	90 Degree Medium No Hold Open
CRL9760	90 Degree Adjustable Spring Hold Open
CRL9762	90 Degree Adjustable Spring No Hold Open



Typical Installation Showing Exposed Spindle of Overhead Closer

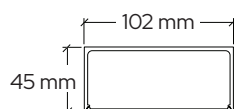

CRL 914 mm Single Door Header

- Includes Snap-In Cover Plates With All Door Closer Fabrication Completed

CODE	DESCRIPTION
DCH4SAS	914 mm Header Kit Satin Anodised
DCH4BSS	914 mm Header Kit Brushed Stainless

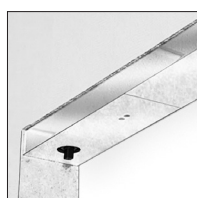

CRL 1829 mm Double Door Header

- Includes Snap-In Cover Plates with all Door Closer Fabrication Completed.

CODE	DESCRIPTION
DCH4SAD	1829 mm Header Kit Satin Anodised
DCH4BSD	1829 mm Header Kit Brushed Stainless

FLOOR MOUNTED DOOR CLOSERS

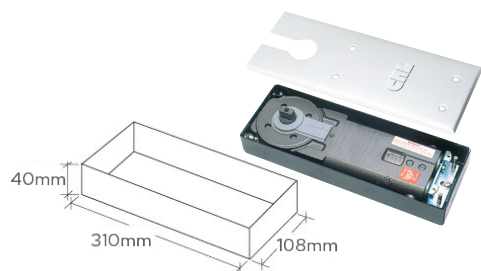

CRL 8300 Series Shallow Depth Floor Mounted Door Closers

- 120 kg Capacity, for Doors Up to 1067 mm Wide
- Low Profile 40 mm Depth
- Interchangeable Spindle Heights
- 5 Year Limited Warranty

CODE	DESCRIPTION
------	-------------

- | | |
|-------------------------|--|
| CRL8360 | 90 Degree Hold Open Medium Duty Low Profile |
| CRL8372 | 105 Degree Non Hold Open Medium Duty Low Profile |

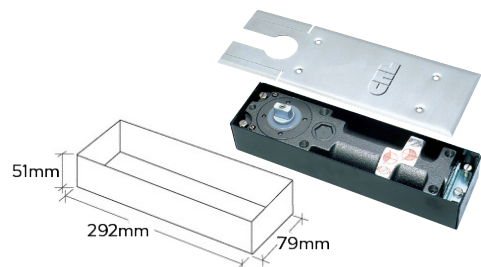

CRL8400 Series Narrow Width Floor Mounted Door Closers

- 120 kg Capacity, for Doors Up to 1067 mm Wide
- Narrow 78 mm Width
- Interchangeable Spindle Heights
- 5 Year Limited Warranty

CODE	DESCRIPTION
------	-------------

- | | |
|-------------------------|---|
| CRL8460 | 90 Degree Hold Open Medium Duty Narrow Floor Mounted |
| CRL8462 | 180 Degree Non Hold Open Medium Duty Narrow Floor Mounted |

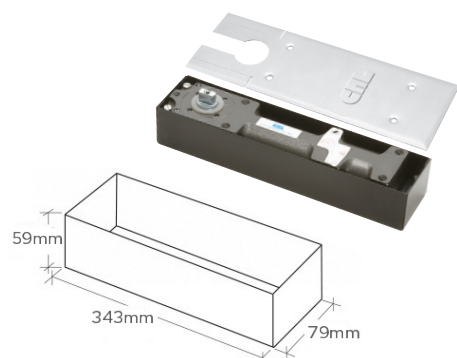

CRL8500 Series Heavy Weight Floor Mounted Door Closers

- 363 kg Capacity, for Doors Up to 1.37m Wide
- Interchangeable Spindle Heights
- Independent Closing and Latching
- Speed Adjustments
- 5 Year Limited Warranty

CODE	DESCRIPTION
------	-------------

- | | |
|-------------------------|---|
| CRL8532 | 180 Degree Non Hold Open Size 3 Spring Heavy-Duty |
| CRL8534 | 90 Degree Hold Open Size 3 Spring Heavy-Duty |
| CRL8542 | 180 Degree Non Hold Open Size 4 Spring Heavy-Duty |
| CRL8544 | 90 Degree Hold Open Size 4 Spring Heavy-Duty |
| CRL8552 | 180 Degree Non Hold Open Size 5 Spring Heavy-Duty |
| CRL8552 | 90 Degree Hold Open Size 5 Spring Heavy-Duty |

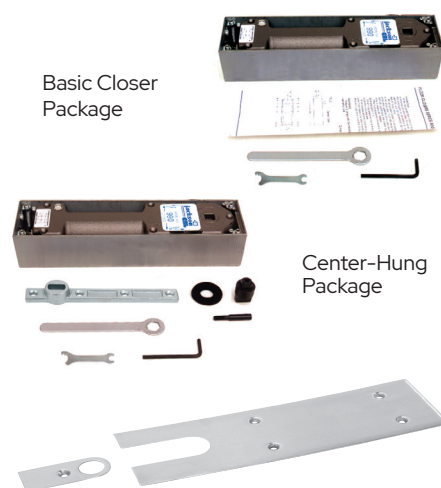

CRL Jackson 900 Series Heavy-Duty Floor Mounted Door Closers

- 454 kg Capacity, for Door Up to 1.37m Wide
- Multi-Size Adjustable Spring Power
- Interchangeable Spindle Heights
- Leveling and Door Centering Adjustments
- 10 Year Limited Warranty

BASIC CLOSER PACKAGE CODE	CENTRE HUNG PACKAGE CODE	DESCRIPTION
J990NH0D	J990NH0N	Non Hold Open Jackson Package
J993H0D	J993H0N	90 Degree & 120 Deg Dual Hold Open Jackson Package

COVER PLATE

- | | |
|---------------------------|--|
| J7020CPBS | Jackson Cover Plate Brushed Stainless |
| J7020CPPS | Jackson Cover Plate Polished Stainless |

CRL Interchangeable Floor Closer Spindles

- Fit All CRL8300, CRL8400, and CRL8500 Series Floor Mounted Door Closers



Flat Tapered

CODE	COLLAR HEIGHTS/ DR DOOR CLEARANCE	STANDARD DOOR CLEARANCE
CRL9040S3	3 mm	8 mm
CRL9040S8	8 mm	13 mm
CRL9040S13	13 mm	17 mm
CRL9040S18	19 mm	24 mm
CRL9040S23	22 mm	27 mm
CRL9040S28	29 mm	33 mm
CRL9040S33	33 mm	38 mm

FREE SWINGING PIVOTS



CRL Floor Mounted Bottom Free-Swinging Pivot

CRL Floor Mounted Free-Swinging Pivot has a 22 mm flat tapered type spindle with a weight capacity of 200 kg which suits CRL Patches and Door Rail Systems.

CAT. NO.	DESCRIPTION
1NT402	Bottom Free-Swinging Pivot to suit Tapered Inserts Arms
1NT402S5	5 mm Packing Shim for 1NT402 Pivot
1NT402CBS	1NT402 Brushed Stainless Cover Plate
1NT402CPS	1NT402 Polished Stainless Cover Plate

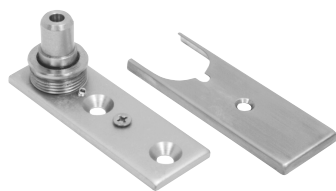

CRL Adjustable Free-Swinging Floor Mounted Bottom Pivot

This CRL Adjustable Threshold or Floor Mount Bottom Free-Swinging Pivot provides 5 mm height adjustment and is ideal for use with our PH10C and PH11C Bottom Door Patch Fittings. This pivot provides a 100 kg weight capacity to support average doors commonly used with Patch Fittings. A brushed stainless Cover Plate is provided to finish the installation. The minimal clearance is 10 mm and this can be adjusted to 15 mm.

CAT. NO.	DESCRIPTION	FINISH
1NT403	Adjustable Free swinging Floor Mount Pivot	Brushed Stainless

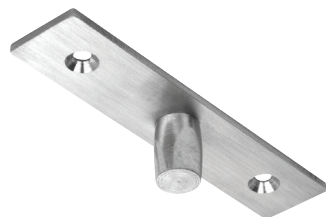

CRL Brushed Stainless Top Center-Hung Free Swing Pivot

This CRL 15 mm Diameter Free-Swinging Top Pivot installs easily to wood or metal substrates to work with CRL door rails, patch fittings and a variety of other top door arm fittings which receive a 15 mm diameter pin. Brushed stainless finish. Mounting screws are not included.

CAT. NO.	DESCRIPTION	FINISH
1NT401	Free-swinging Top Pivot	Brushed Stainless



CRL Header Mounted Top Free-Swinging Pivot

This CRL Header Mounted Free-Swinging Top Pivot is secured in masonry, or to metal, to allow for a free-swinging pivot. For use with Patch Fittings such as Cat. Nos. PH20A, and PH21A or any Top Pivot with a 15 mm diameter hole. Secure in masonry with the included brass masonry anchor, or secure to metal in a tapped 8 mm threaded hole.

CAT. NO.	DESCRIPTION	FINISH
1NT405	Free-swinging Header Mount Top Pivot	Satin

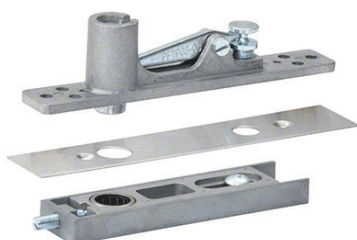

CRL Center-Hung Top Pivot Set with Cover

The CRL Center-Hung "Walking Beam" Top Pivot is intended for use with Floor Closers and center-hung free-swing floor pivots. The door arm provides lateral adjustment to assure that the door is plumb. These Pivots are fully mortised and non-handed. Pivot pin 15 mm diameter and accommodates top door clearance up to 13 mm. Supplied with finished cover plate.

CAT. NO.	DESCRIPTION	FINISH
CRL860BS	Free-swinging Top Pivot	Brushed Stainless
CRL860PS	Free-swinging Top Pivot	Polished Stainless
CRL860MBL	Free-swinging Top Pivot	Matt Black

**CRL Glass Mounted Lockable Latch**

- For 10 or 12 mm Toughened Glass
- Lever Handles Not Included - See Below
- Includes Key/Key & Key/Thumbturn Cylinders



CODE	DESCRIPTION
PTH311BS	CRL Glass Mounted Latch w/ Lock/Turn Brushed Stainless
PTH311PS	CRL Glass Mounted Latch w/ Lock/Turn Polished Stainless
PTH311A	CRL Glass Mounted Latch w/ Lock/Turn Satin Anodised
PTH311MBL	CRL Glass Mounted Latch w/ Lock/Turn Matt Black

**CRL Glass Mounted Passage Latch**

- For 10 or 12 mm Toughened Glass
- Lever Handles Not Included - See Below

CODE	DESCRIPTION
PTH312BS	CRL Glass Mounted Passage Latch Brushed Stainless
PTH312PS	CRL Glass Mounted Passage Latch Polished Stainless
PTH312A	CRL Glass Mounted Passage Latch Satin Anodised
PTH312MBL	CRL Glass Mounted Passage Latch Matt Black

**CRL Glass Mounted Latch Keeper**

- For 10 or 12 mm Toughened Glass
- Works with Either Latch Above on Double Doors

CODE	DESCRIPTION
PTH314BS	CRL PTH Glass Mounted Keeper Brushed Stainless
PTH314PS	CRL PTH Glass Mounted Keeper Polished Stainless
PTH314A	CRL PTH Glass Mounted Keeper Satin Anodised
PTH314MBL	CRL PTH Glass Mounted Keeper Matt Black

**CRL Tubular Style Lever Handles**

- For Use with PTH311 and PTH312 Glass Mounted Latch Mechanisms

CODE	DESCRIPTION
PTH302BS	CRL PTH Tubular Style Lever Handle Brushed Stainless
PTH302PS	CRL PTH Tubular Style Lever Handle Polished Stainless
PTH302A	CRL PTH Tubular Style Lever Handle Satin Anodised
PTH302MBL	CRL PTH Tubular Style Lever Handle Matt Black

**CRL Sculptured Style Lever Handles**

- For Use with PTH311 and PTH312 Glass Mounted Latch Mechanisms

CODE	DESCRIPTION
PTH303BS	CRL PTH Sculptured Style Lever Handle Brushed Stainless
PTH303PS	CRL PTH Sculptured Style Lever Handle Polished Stainless
PTH303MBL	CRL PTH Sculptured Style Lever Handle Matt Black

**CRL Modern Style Lever Handles**

- For Use with PTH311 and PTH312 Glass Mounted Latch Mechanisms

CODE	DESCRIPTION
PTH306BS	CRL PTH Modern Style Lever Handle Brushed Stainless
PTH306PS	CRL PTH Modern Style Lever Handle Polished Stainless
PTH306MBL	CRL PTH Modern Style Lever Handle Matt Black

WET & DRY GLAZE COMMERCIAL U-CHANNEL

25 mm x 25 mm Wet/Dry Glaze U-Channel

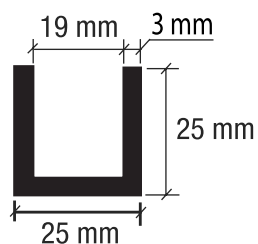
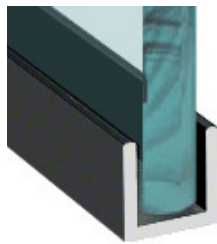

- 25mm Exterior Height
- Typically Used at the Bottom of Glass Panels
- Use With Silicone (Wet) or Glazing Gasket (Dry)
- Matching End Caps Sold Separately (See Opposite Page)
- Available in 3.05 m and 6.10 m Lengths

3.05M LENGTH CAT. NO.	6.10M LENGTH CAT. NO.	DESCRIPTION	FINISHES
WU3SASL	WU3SA240	25 mm x 25 mm Channel	Satin Anodised
WU3BSASL	WU3BSA240	25 mm x 25 mm Channel	Brushed Stainless Anodised
WU3MBLSL	WU3MBL240	25 mm x 25 mm Channel	Matt Black
WU3BASL	WU3BA240	25 mm x 25 mm Channel	Bright Anodised

38 mm x 25 mm Wet/Dry Glaze U-Channel

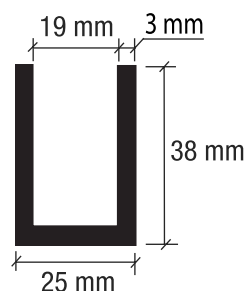
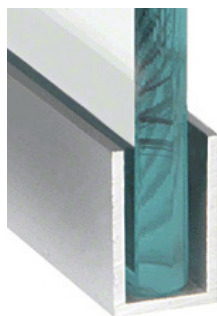

- 38mm Exterior Height
- Typically Used at the Bottom & Top of Glass Panels
- Use With Silicone (Wet) or Glazing Gasket (Dry)
- Matching End Caps Sold Separately (See Opposite Page)
- Available in 3.05 m and 6.10 m Lengths

3.05M LENGTH CAT. NO.	6.10M LENGTH CAT. NO.	DESCRIPTION	FINISHES
WU1SASL	WU1SA240	38 mm x 25 mm Channel	Satin Anodised
WU1BSASL	WU1BSA240	38 mm x 25 mm Channel	Brushed Stainless Anodised
WU1MBLSL	WU1MBL240	38 mm x 25 mm Channel	Matt Black
WU1BASL	WU1BA240	38 mm x 25 mm Channel	Bright Anodised

51 mm x 25 mm Wet/Dry Glaze U-Channel

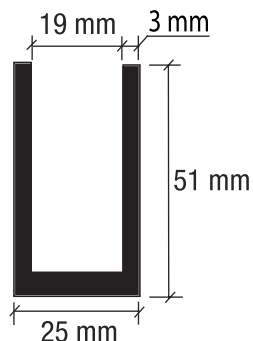
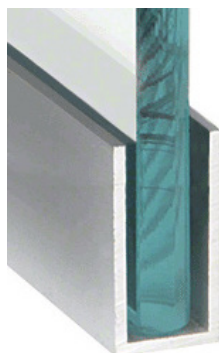

- 51mm Exterior Height
- Typically Used at the Top of Glass Panels
- Use With Silicone (Wet) or Glazing Gasket (Dry)
- Matching End Caps Sold Separately (See Opposite Page)
- Available in 3.05 m and 6.10 m Lengths

3.05M LENGTH CAT. NO.	6.10M LENGTH CAT. NO.	DESCRIPTION	FINISHES
WU2SASL	WU2SA240	51 mm x 25 mm Channel	Satin Anodised
WU2BSASL	WU2BSA240	51 mm x 25 mm Channel	Brushed Stainless Anodised
WU2MBLSL	WU2MBL240	51 mm x 25 mm Channel	Matt Black
WU2BASL	WU2BA240	51 mm x 25 mm Channel	Bright Anodised

WET & DRY GLAZE COMMERCIAL U-CHANNEL

25 mm x 25 mm Wet/Dry Glaze U-Channel

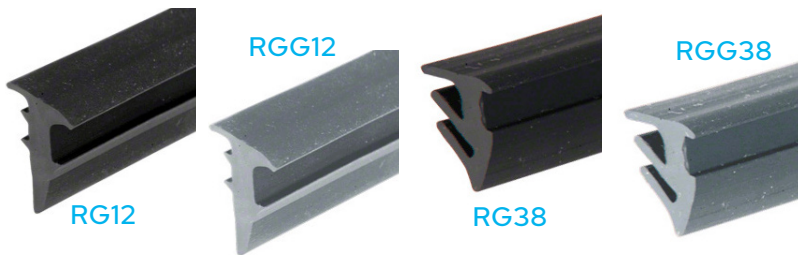

Roll-In Glazing Gasket provides an easy way of glazing glass. It eliminates using messy silicone sealant and the clean up that follows. Black or Grey colour material can be used with all finishes of the Wet/Dry U-Channel.

30.5M LENGTH CAT. NO.	152M ROLL CAT. NO.	DESCRIPTION	FINISHES
RG38100	RG38500	10 mm Glass Vinyl	Black
RGG38100		10 mm Glass Vinyl	Grey
RG12100	RG12500	12 mm Glass Vinyl	Black
RGG12100		12 mm Glass Vinyl	Grey

25 mm x 25 mm U-Channel End Caps



- Fits WU3 25mm x 25mm Series U-Channel
- Finishes off Exposed Ends
- Easy to Install with Silicone Sealant
- Four Matching Finishes Available

CAT. NO.	DESCRIPTION	FINISHES
WU3ECSA	25 mm x 25 mm Channel End Cap	Satin Anodised
WU3ECBSA	25 mm x 25 mm Channel End Cap	Brushed Stainless Anodised
WU3ECMBL	25 mm x 25 mm Channel End Cap	Matt Black
WU3ECBA	25 mm x 25 mm Channel End Cap	Bright Anodised

38 mm x 25 mm U-Channel End Caps



- Fits WU1 38mm x 25mm Series U-Channel
- Finishes off Exposed Ends
- Easy to Install with Silicone Sealant
- Four Matching Finishes Available

CAT. NO.	DESCRIPTION	FINISHES
WU1ECSA	38 mm x 25 mm Channel End Cap	Satin Anodised
WU1ECBSA	38 mm x 25 mm Channel End Cap	Brushed Stainless Anodised
WU1ECMBL	38 mm x 25 mm Channel End Cap	Matt Black
WU1ECBA	38 mm x 25 mm Channel End Cap	Bright Anodised

51 mm x 25 mm U-Channel End Caps



- Fits WU2 51mm x 25mm Series U-Channel
- Finishes off Exposed Ends
- Easy to Install with Silicone Sealant
- Four Matching Finishes Available

CAT. NO.	DESCRIPTION	FINISHES
WU2ECSA	51 mm x 25 mm Channel End Cap	Satin Anodised
WU2ECBSA	51 mm x 25 mm Channel End Cap	Brushed Stainless Anodised
WU2ECMBL	51 mm x 25 mm Channel End Cap	Matt Black
WU2ECBA	51 mm x 25 mm Channel End Cap	Bright Anodised

LADDER STYLE HANDLES

CRL Ladder Style Back to Back Handles

- Suits 10 mm to 19 mm Thick Glass
- Available in Brushed Stainless, Polished Stainless and Matt Black.
- Supplied with long bolts for Aluminium and Timber Door Applications
- 16 mm Diameter Holes Required in Glass.
- 32 mm Diameter Tubing
- 304 Grade Stainless Steel

CAT. NO.	OVERALL LENGTH	MOUNTING HOLE CENTER	FINISH
LPH600BS	600 mm	300 mm	Brushed Stainless
LPH600PS	600 mm	300 mm	Polished Stainless
LPH600MBL	600 mm	300 mm	Matt Black
LPH900BS	900 mm	600 mm	Brushed Stainless
LPH900PS	900 mm	600 mm	Polished Stainless
LPH900MBL	900 mm	600 mm	Matt Black
LPH1200BS	1200 mm	900mm	Brushed Stainless
LPH1200PS	1200 mm	900mm	Polished Stainless
LPH1200MBL	1200 mm	900mm	Matt Black
LPH1500BS	1500 mm	1200mm	Brushed Stainless
LPH1500PS	1500 mm	1200mm	Polished Stainless
LPH1800BS	1800mm	1500 mm	Brushed Stainless
LPH1800PS	1800mm	1500 mm	Polished Stainless



CRL Offset Ladder Style Back to Back Handles

- Suits 10 mm to 19 mm Thick Glass
- Available in Brushed Stainless, Polished Stainless and Matt Black.
- Supplied with long bolts for Aluminium and Timber Door Applications
- 16 mm Diameter Holes Required in Glass.
- 32 mm Diameter Tubing
- 304 Grade Stainless Steel

CAT. NO.	OVERALL LENGTH	MOUNTING HOLE CENTER	FINISH
OLPH600BS	600 mm	300 mm	Brushed Stainless
OLPH600PS	600 mm	300 mm	Polished Stainless
OLPH600MBL	600 mm	300 mm	Matt Black
OLPH900BS	900 mm	600 mm	Brushed Stainless
OLPH900PS	900 mm	600 mm	Polished Stainless
OLPH900MBL	900 mm	600 mm	Matt Black
OLPH1200BS	1200 mm	900mm	Brushed Stainless
OLPH1200PS	1200 mm	900mm	Polished Stainless
OLPH1200MBL	1200 mm	900mm	Matt Black
OLPH1500BS	1500 mm	1200mm	Brushed Stainless
OLPH1500PS	1500 mm	1200mm	Polished Stainless



LADDER STYLE HANDLES

CRL Square Ladder Style Back to Back Handles

- Suits 10 mm to 19 mm Thick Glass
- Available in Brushed and Polished Stainless Steel.
- Supplied with long bolts for Aluminium and Timber Door Applications
- 16 mm Diameter Holes Required in Glass.
- 32 mm Tubing
- 304 Grade Stainless Steel

CAT. NO.	OVERALL LENGTH	MOUNTING HOLE CENTER	FINISH
SQLPH600BS	600 mm	300 mm	Brushed Stainless
SQLPH600PS	600 mm	300 mm	Polished Stainless
SQLPH600MBL	600 mm	300 mm	Matt Black
SQLPH900BS	900 mm	600 mm	Brushed Stainless
SQLPH900PS	900 mm	600 mm	Polished Stainless
SQLPH900MBL	900 mm	600 mm	Matt Black
SQLPH1200BS	1200 mm	900mm	Brushed Stainless
SQLPH1200PS	1200 mm	900mm	Polished Stainless
SQLPH1200MBL	1200 mm	900mm	Matt Black
SQLPH1500BS	1500 mm	1200mm	Brushed Stainless
SQLPH1500PS	1500 mm	1200mm	Polished Stainless

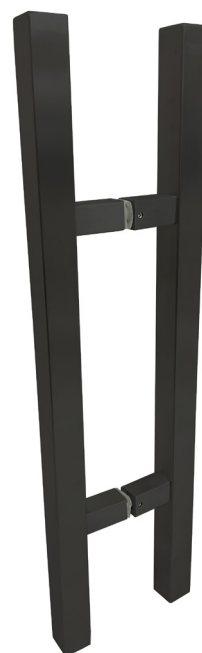

CRL Offset Square Ladder Style Back to Back Handles

- Suits 10 mm to 19 mm Thick Glass
- Available in Brushed and Polished Stainless Steel.
- Supplied with long bolts for Aluminium and Timber Door Applications
- 16 mm Diameter Holes Required in Glass.
- 32 mm Tubing
- 304 Grade Stainless Steel

CAT. NO.	OVERALL LENGTH	MOUNTING HOLE CENTER	FINISH
OSQLPH600BS	600 mm	300 mm	Brushed Stainless
OSQLPH600PS	600 mm	300 mm	Polished Stainless
OSQLPH600MBL	600 mm	300 mm	Matt Black
OSQLPH900BS	900 mm	600 mm	Brushed Stainless
OSQLPH900PS	900 mm	600 mm	Polished Stainless
OSQLPH900MBL	900 mm	600 mm	Matt Black
OSQLPH1200BS	1200 mm	900mm	Brushed Stainless
OSQLPH1200PS	1200 mm	900mm	Polished Stainless
OSQLPH1200MBL	1200 mm	900mm	Matt Black
OSQLPH1500BS	1500 mm	1200mm	Brushed Stainless
OSQLPH1500PS	1500 mm	1200mm	Polished Stainless



CRL “D” & SQUARE STYLE HANDLES

CRL “D” Back to Back Handles

- Suits 10 mm to 19 mm Thick Glass
- Available in Brushed Stainless, Polished Stainless and Matt Black.
- Supplied with long bolts for Aluminium and Timber Door Applications
- 16 mm Diameter Holes Required in Glass.
- 32 mm Diameter Tubing
- 304 Grade Stainless Steel

CAT. NO.	OVERALL LENGTH	MOUNTING HOLE CENTER	FINISH
CDH300BS	300 mm	300 mm	Brushed Stainless
CDH300PS	300 mm	300 mm	Polished Stainless
CDH450BS	450 mm	450 mm	Brushed Stainless
CDH450PS	450 mm	450 mm	Polished Stainless
CDH450MBL	450 mm	450 mm	Matt Black
CDH600BS	600 mm	600 mm	Brushed Stainless
CDH600PS	600 mm	600 mm	Polished Stainless
CDH600MBL	600 mm	600 mm	Matt Black
CDH900BS	900 mm	900 mm	Brushed Stainless
CDH900PS	900 mm	900 mm	Polished Stainless
CDH1200BS	1200 mm	1200 mm	Brushed Stainless
CDH1200PS	1200 mm	1200 mm	Polished Stainless
CDH1200MBL	1200 mm	1200 mm	Matt Black



CRL Offset “D” Back to Back Handles

- Suits 10 mm to 19 mm Thick Glass
- Available in Brushed Stainless, Polished Stainless and Matt Black.
- Supplied with long bolts for Aluminium and Timber Door Applications
- 16 mm Diameter Holes Required in Glass.
- 32 mm Diameter Tubing
- 304 Grade Stainless Steel

CAT. NO.	OVERALL LENGTH	MOUNTING HOLE CENTER	FINISH
OCDH300BS	300 mm	300 mm	Brushed Stainless
OCDH300PS	300 mm	300 mm	Polished Stainless
OCDH450BS	450 mm	450 mm	Brushed Stainless
OCDH450PS	450 mm	450 mm	Polished Stainless
OCDH450MBL	450 mm	450 mm	Matt Black
OCDH600BS	600 mm	600 mm	Brushed Stainless
OCDH600PS	600 mm	600 mm	Polished Stainless
OCDH600MBL	600 mm	600 mm	Matt Black
OCDH900BS	900 mm	900 mm	Brushed Stainless
OCDH900PS	900 mm	900 mm	Polished Stainless
OCDH1200BS	1200 mm	1200 mm	Brushed Stainless
OCDH1200PS	1200 mm	1200 mm	Polished Stainless



CRL “D” & SQUARE STYLE HANDLES

CRL Square Back to Back Handles

- Suits 10 mm to 19 mm Thick Glass
- Available in Brushed and Polished Stainless Steel.
- Supplied with long bolts for Aluminium and Timber Door Applications
- 16 mm Diameter Holes Required in Glass.
- 25 mm Tubing
- 304 Grade Stainless Steel

CAT. NO.	OVERALL LENGTH	MOUNTING HOLE CENTER	FINISH
SQCDH300BS	300 mm	300 mm	Brushed Stainless
SQCDH300PS	300 mm	300 mm	Polished Stainless
SQCDH450BS	450 mm	450 mm	Brushed Stainless
SQCDH450PS	450 mm	450 mm	Polished Stainless
SQCDH450MBL	450 mm	450 mm	Matt Black
SQCDH600BS	600 mm	600 mm	Brushed Stainless
SQCDH600PS	600 mm	600 mm	Polished Stainless
SQCDH600MBL	600 mm	600 mm	Matt Black
SQCDH900BS	900 mm	900 mm	Brushed Stainless
SQCDH900PS	900 mm	900 mm	Polished Stainless
SQCDH1200BS	1200 mm	1200 mm	Brushed Stainless
SQCDH1200PS	1200 mm	1200 mm	Polished Stainless
SQCDH1200MBL	1200 mm	1200 mm	Matt Black



CRL Offset Square Back to Back Handles

- Suits 10 mm to 19 mm Thick Glass
- Available in Brushed and Polished Stainless Steel.
- Supplied with long bolts for Aluminium and Timber Door Applications
- 16 mm Diameter Holes Required in Glass.
- 25 mm Tubing
- 304 Grade Stainless Steel

CAT. NO.	OVERALL LENGTH	MOUNTING HOLE CENTER	FINISH
OSQCDH300BS	300 mm	300 mm	Brushed Stainless
OSQCDH300PS	300 mm	300 mm	Polished Stainless
OSQCDH450BS	450 mm	450 mm	Brushed Stainless
OSQCDH450PS	450 mm	450 mm	Polished Stainless
OSQCDH450MBL	450 mm	450 mm	Matt Black
OSQCDH600BS	600 mm	600 mm	Brushed Stainless
OSQCDH600PS	600 mm	600 mm	Polished Stainless
OSQCDH600MBL	600 mm	600 mm	Matt Black
OSQCDH900BS	900 mm	900 mm	Brushed Stainless
OSQCDH900PS	900 mm	900 mm	Polished Stainless
OSQCDH1200BS	1200 mm	1200 mm	Brushed Stainless
OSQCDH1200PS	1200 mm	1200 mm	Polished Stainless
OSQCDH1200MBL	1200 mm	1200 mm	Matt Black





Call on 1800 424 275
Fax on 1800 813 013

Melbourne

42 Enterprise Drive
Rowville
VIC 3178
Tel. +61 3 9764 8322

Sydney

9 Shale Place
Eastern Creek
NSW 2766
Tel. +61 2 9851 3444

Enquiries

Email: crlaus@crlaurence.com

www.crlaurence.com.au